

PANZER German Sd.Kfz.9/2 Conversion

CONCEPTS Designed to fit Tamiya "Famo" Kit #35239

PANZERCONCEPTS.COM 35020 1/35 Scale

Printed resin is a harder and more fragile so care must be used in removing the supports. The best results can be achieved by using flush cutters (Tamiya). Sand all contact points with a fine file or sanding board all parts can be attached using cyanoacrylate. If any parts are warped they can be straightened with hot water and/or heat gun.

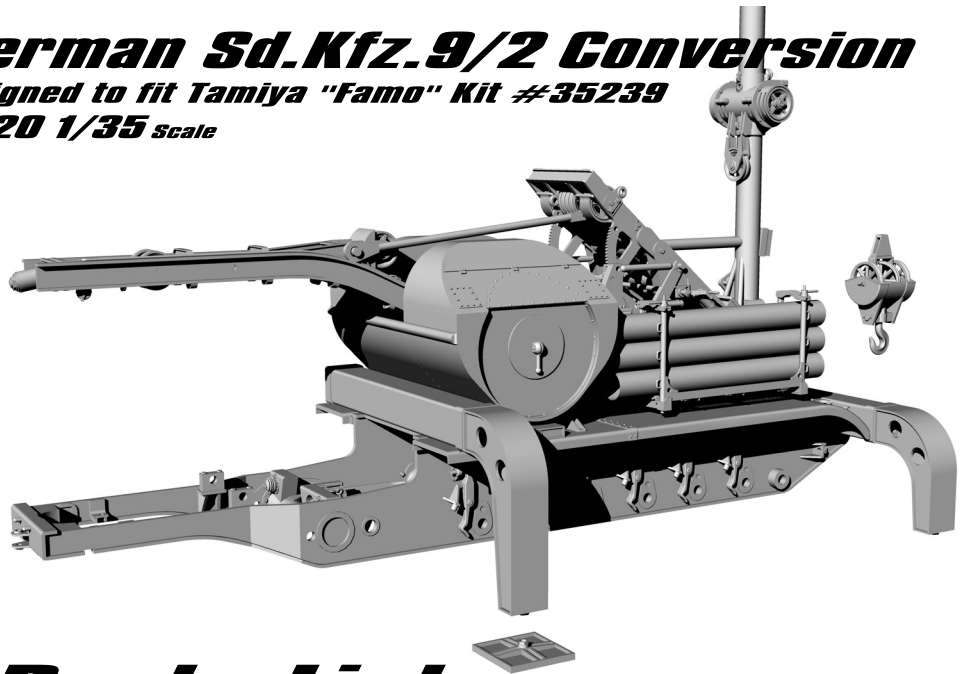

Parts List

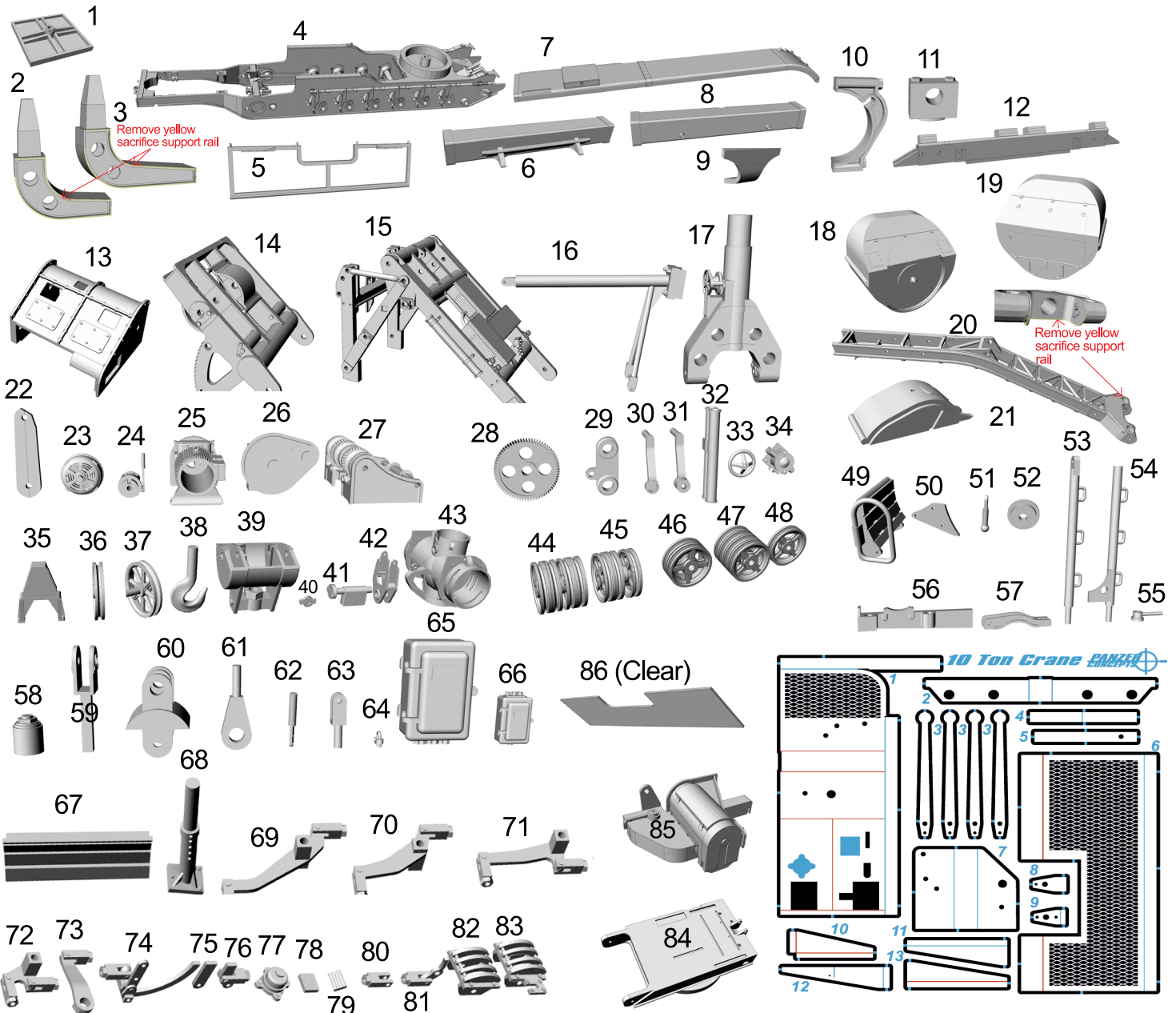

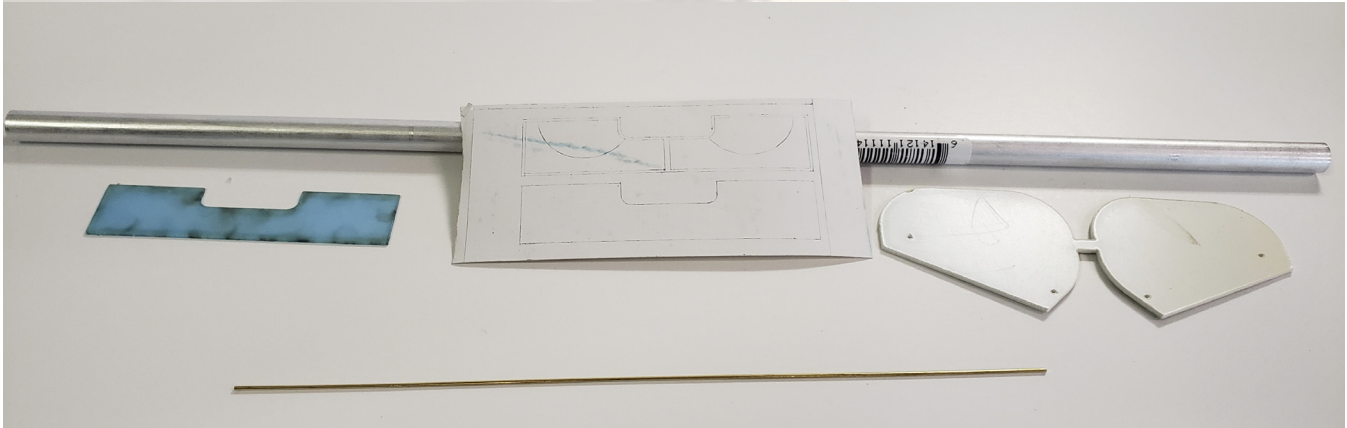
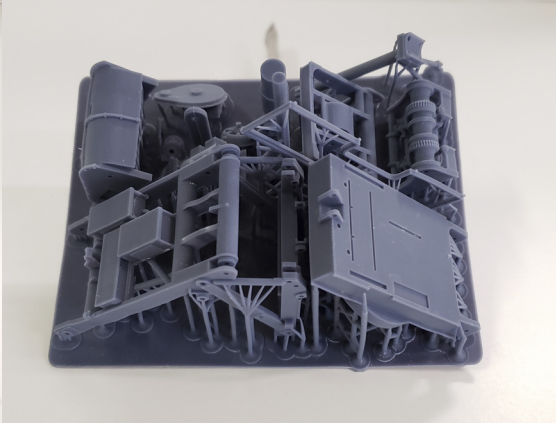
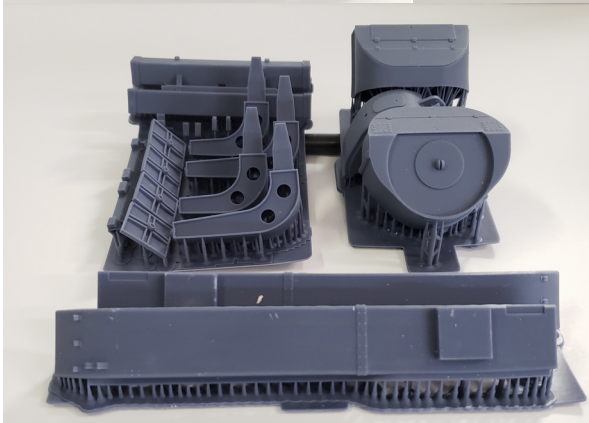
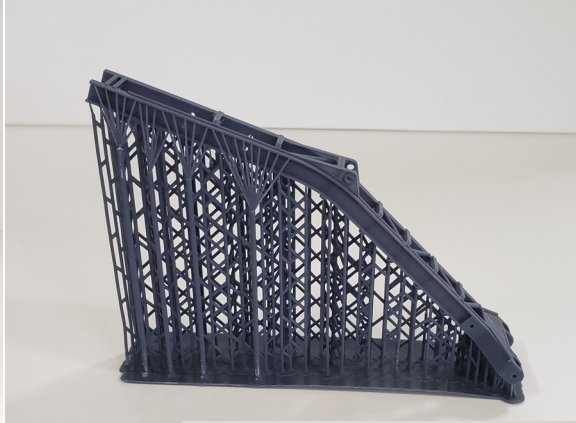
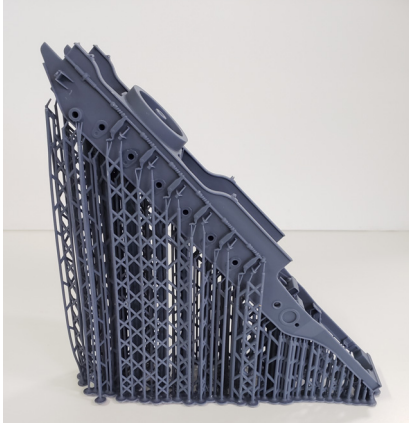

1

Drill driveshafts
.01

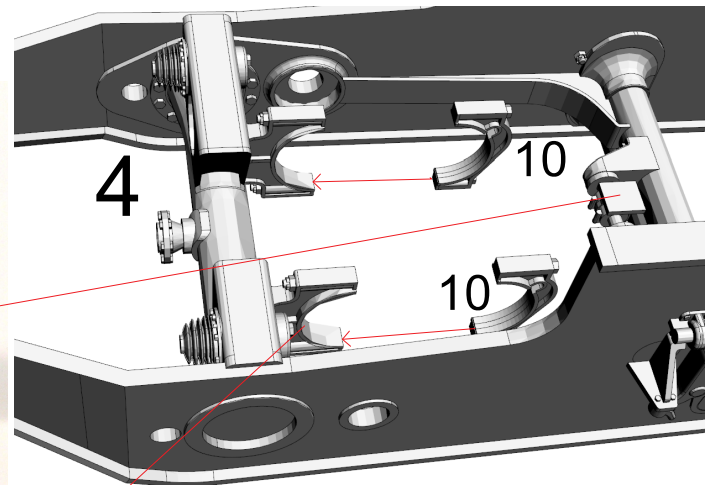
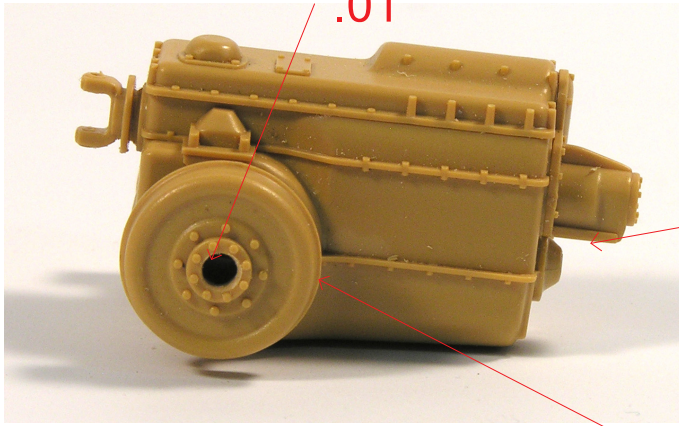

Tamiya transmission fits on part 10
behind break drum then slide .01 rod
through frame and transmission

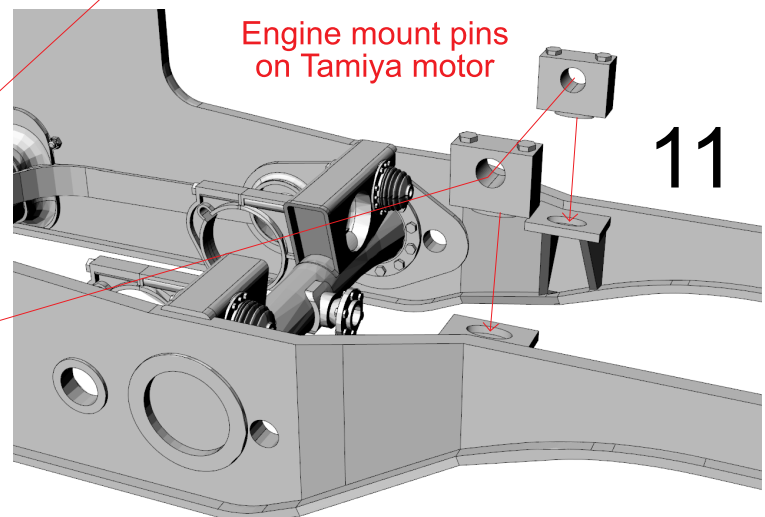
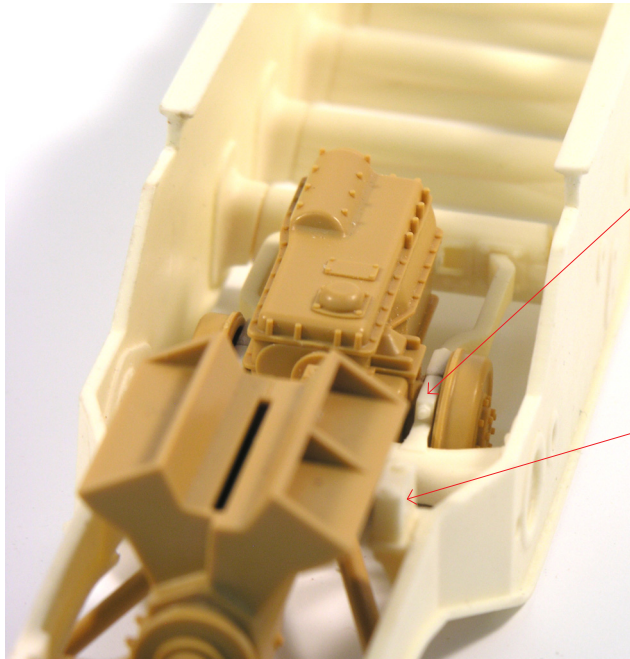

Engine mount pins
on Tamiya motor

Build rest of frame as per Tamiya instructions

2

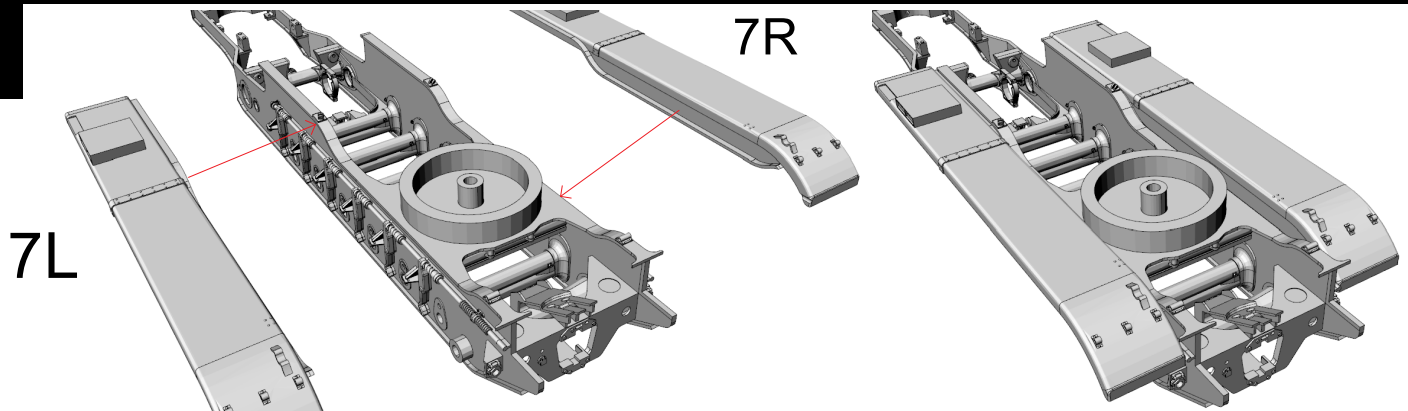

3

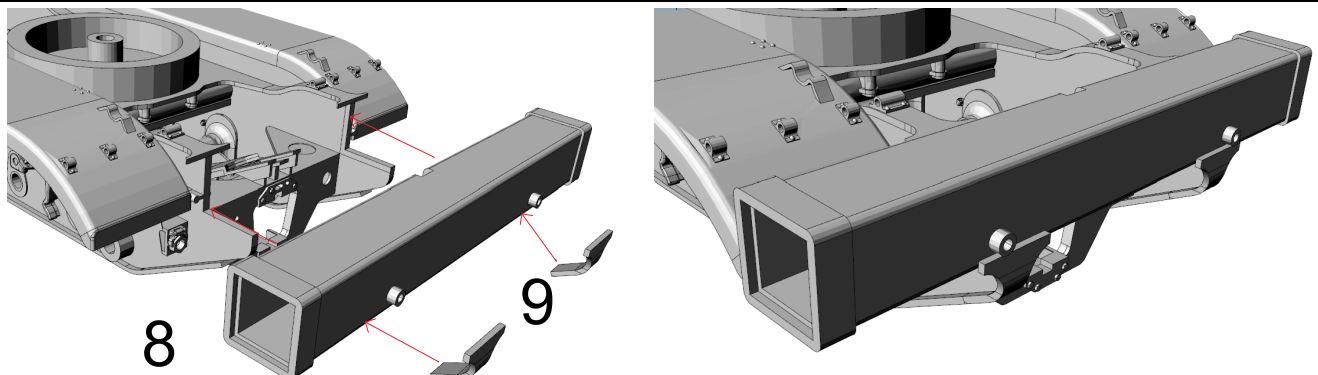

4

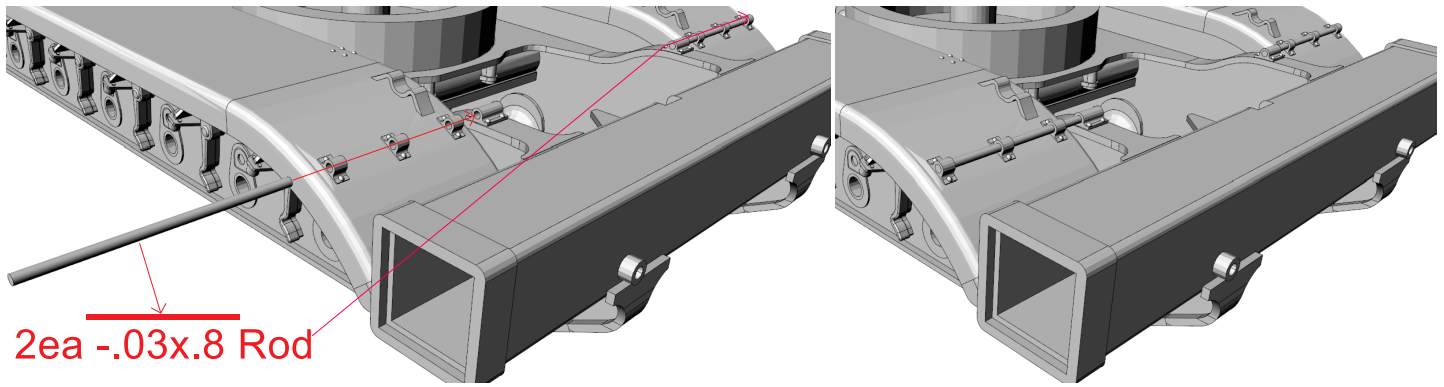

5

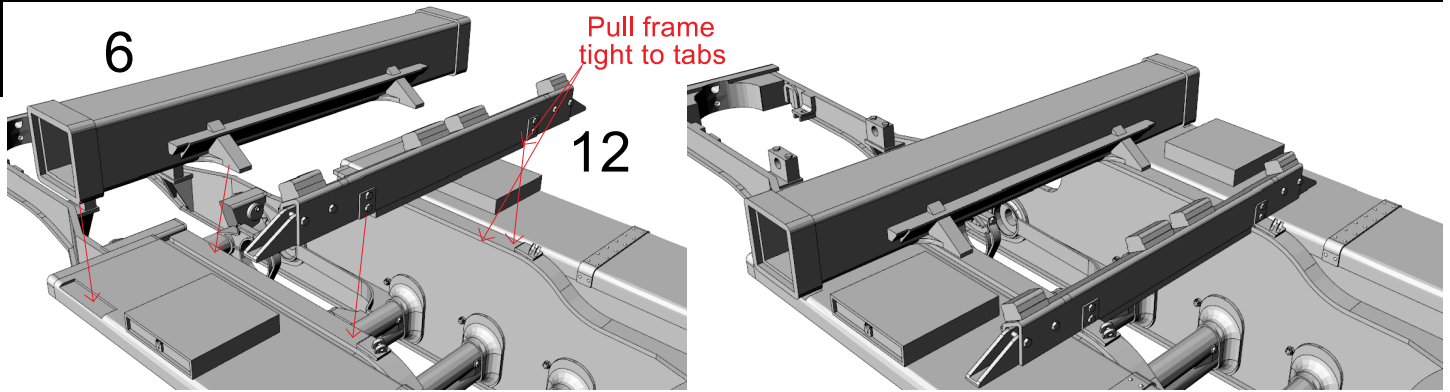

6

These are the counterweight lock downs are positional

62

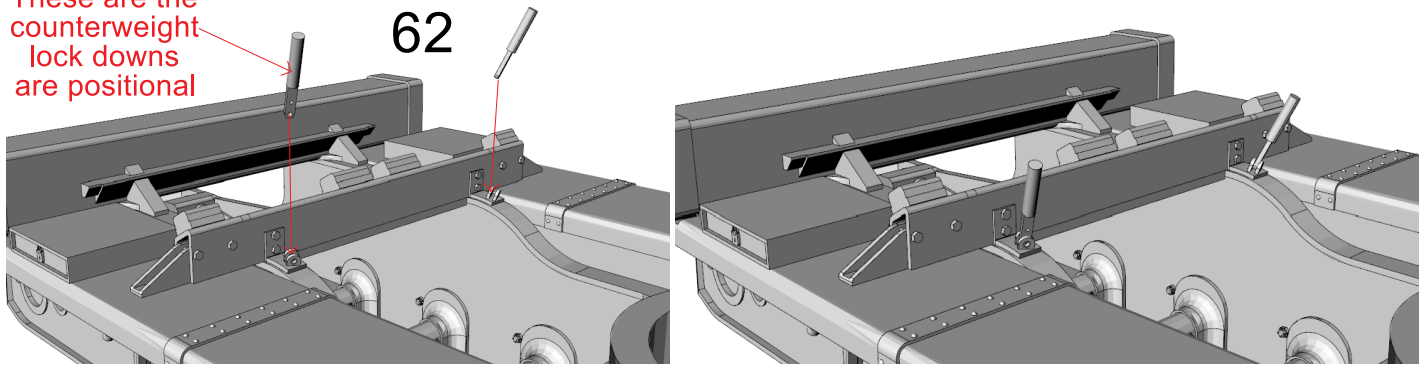

7

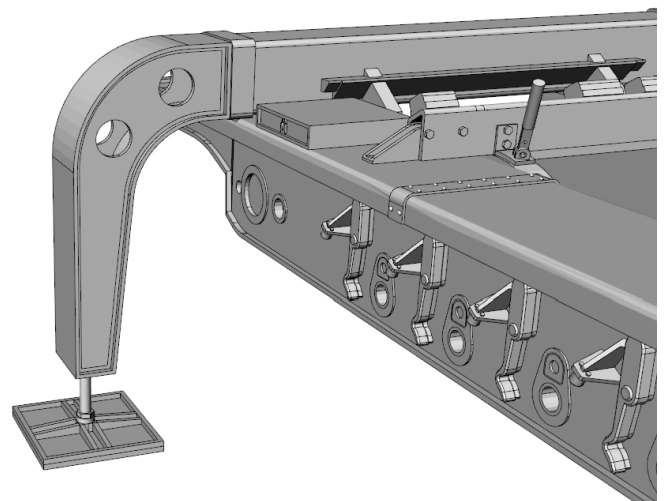
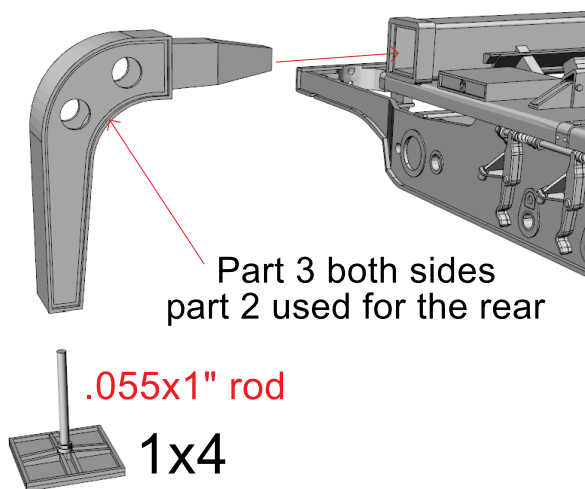

Outriggers were used when the crane is in the operating position
 These were stored in a separate trailer when not used.
 (Das Werk 5 ton trailer (#35006) would fill this role)

8

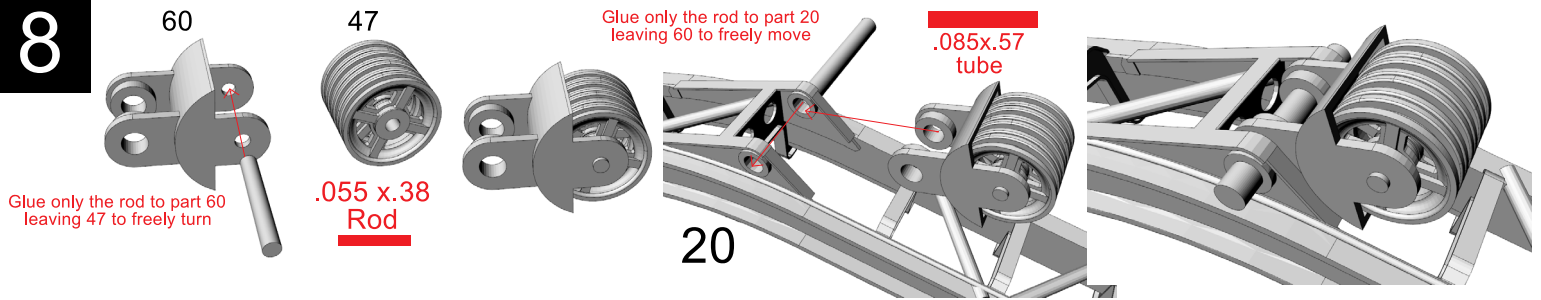

9

For easier rigging do not glue assembly to frame 20 at this time , Wait until you run the cable through pulley assembly then glue 58 to 59. (Just test fit at this time)

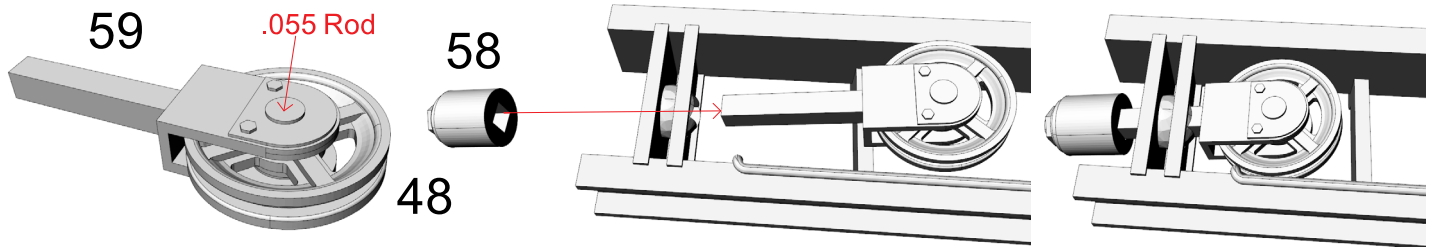

10

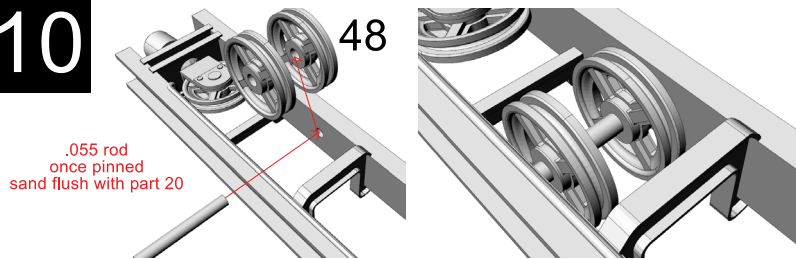

11

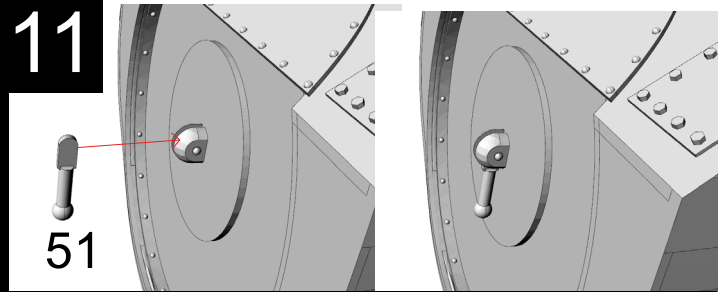

12

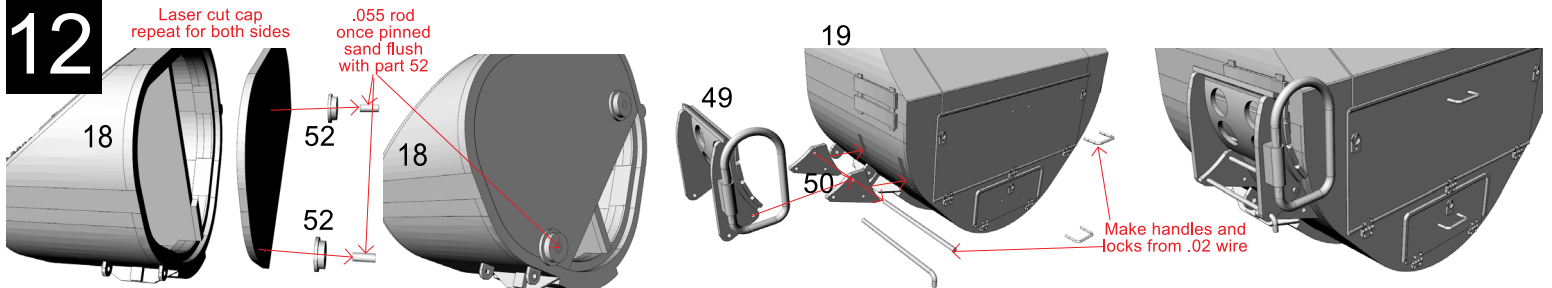

13

For easier rigging do not glue assembly to frame 20 at this time Wait until you ready to run cable (Just test fit at this time)



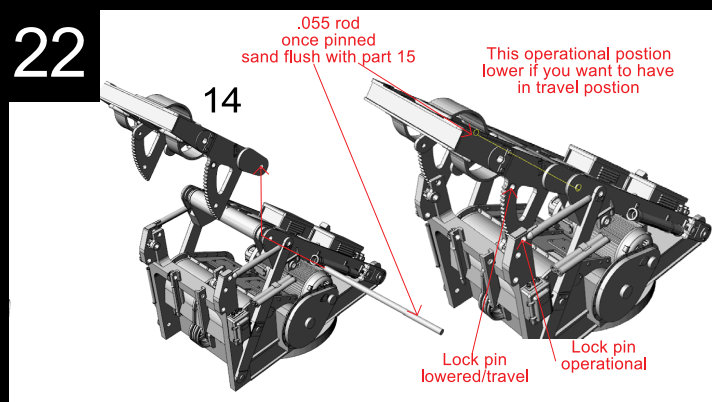
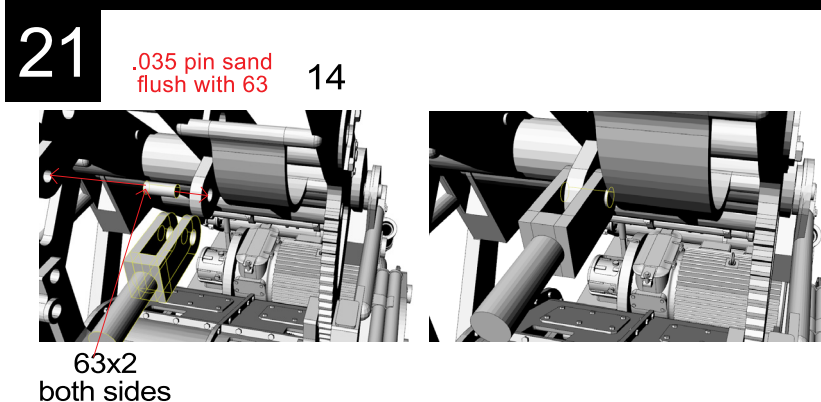
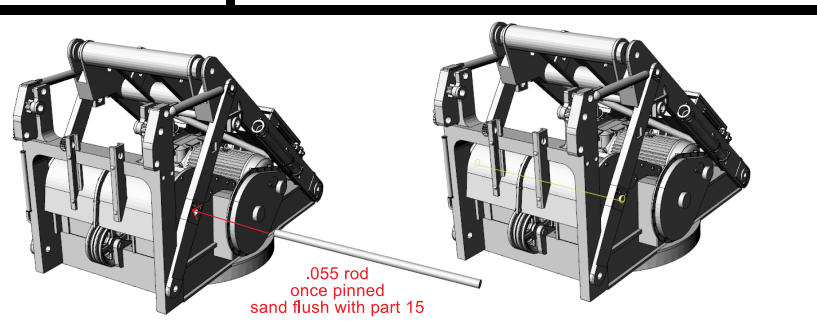
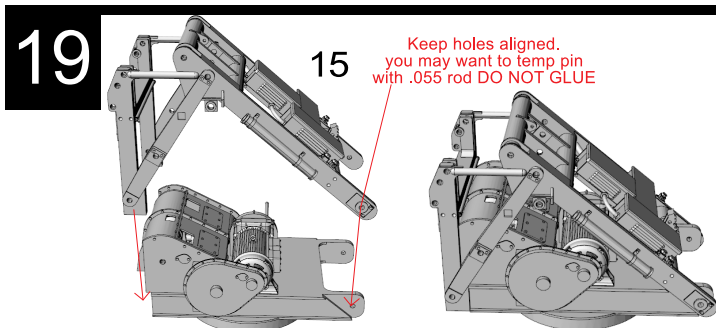
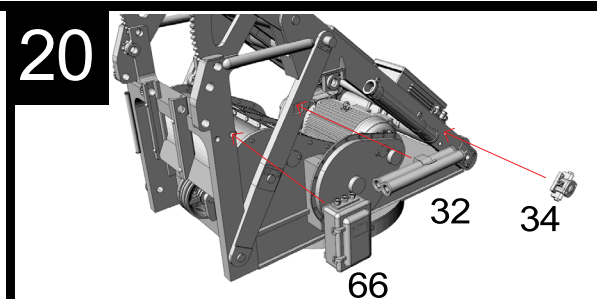
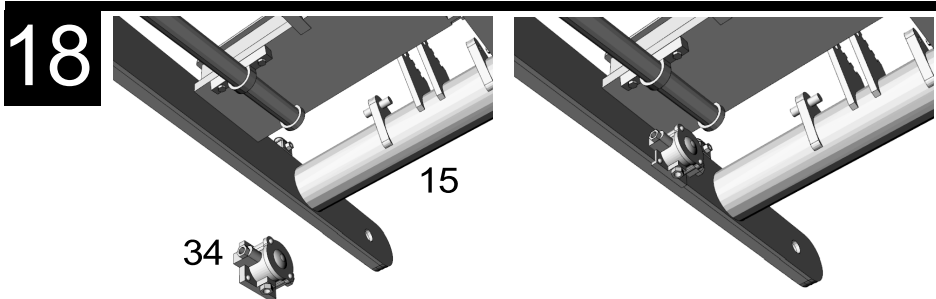
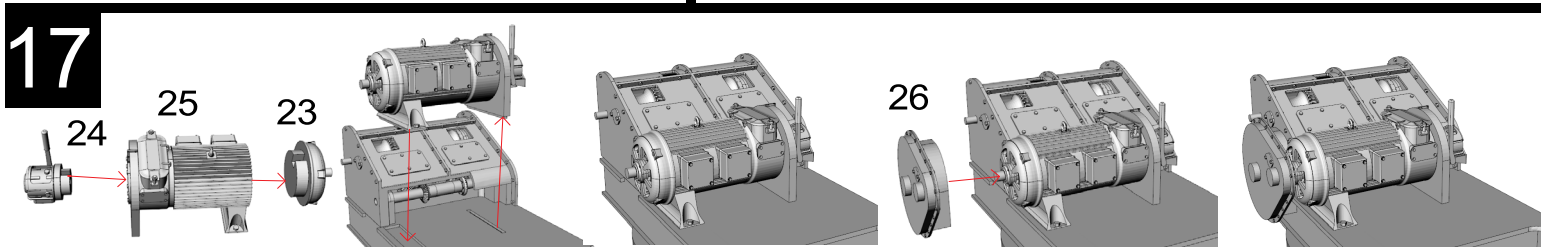
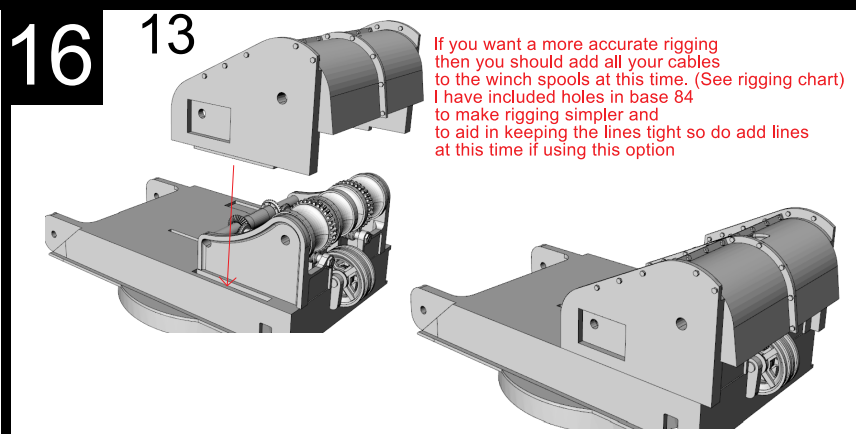
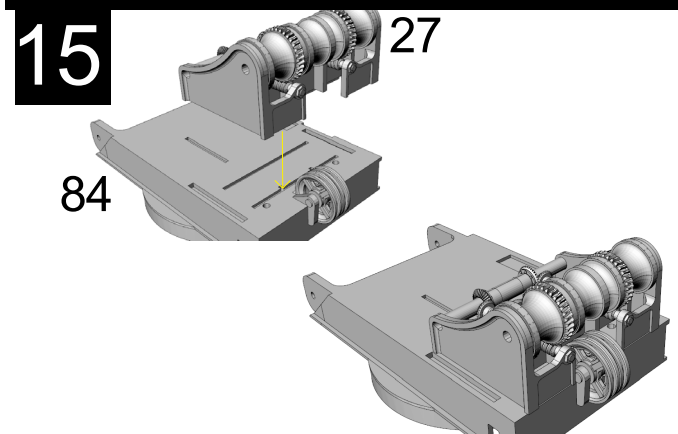
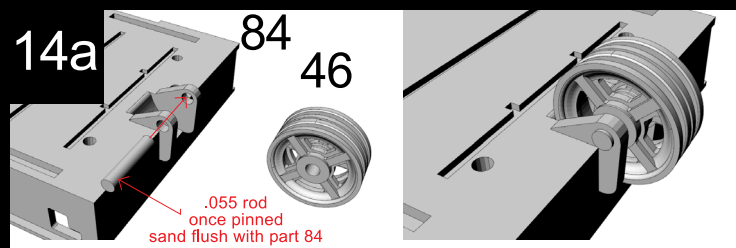
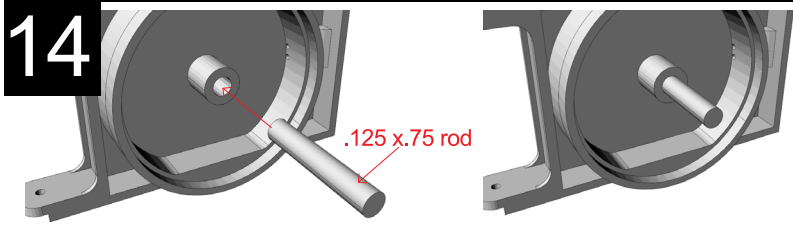

23

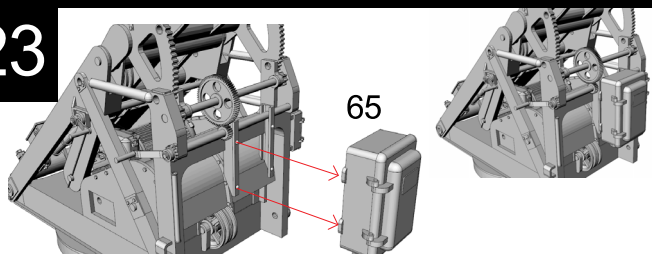

24

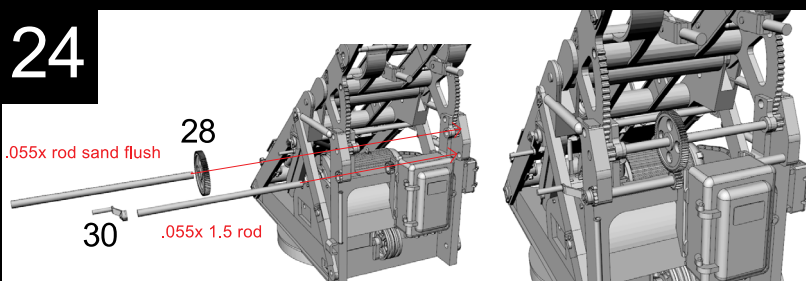

25

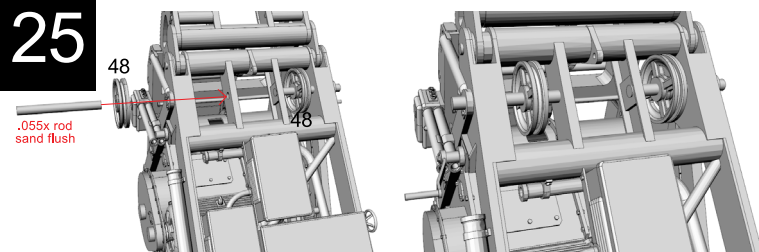

26

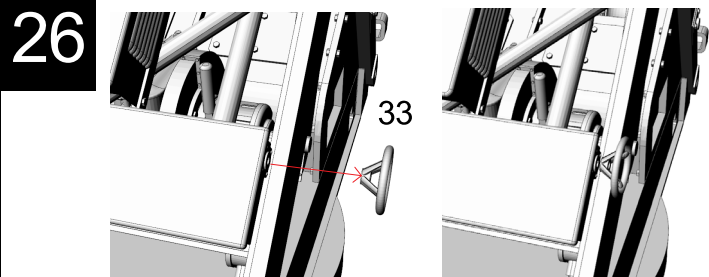

27

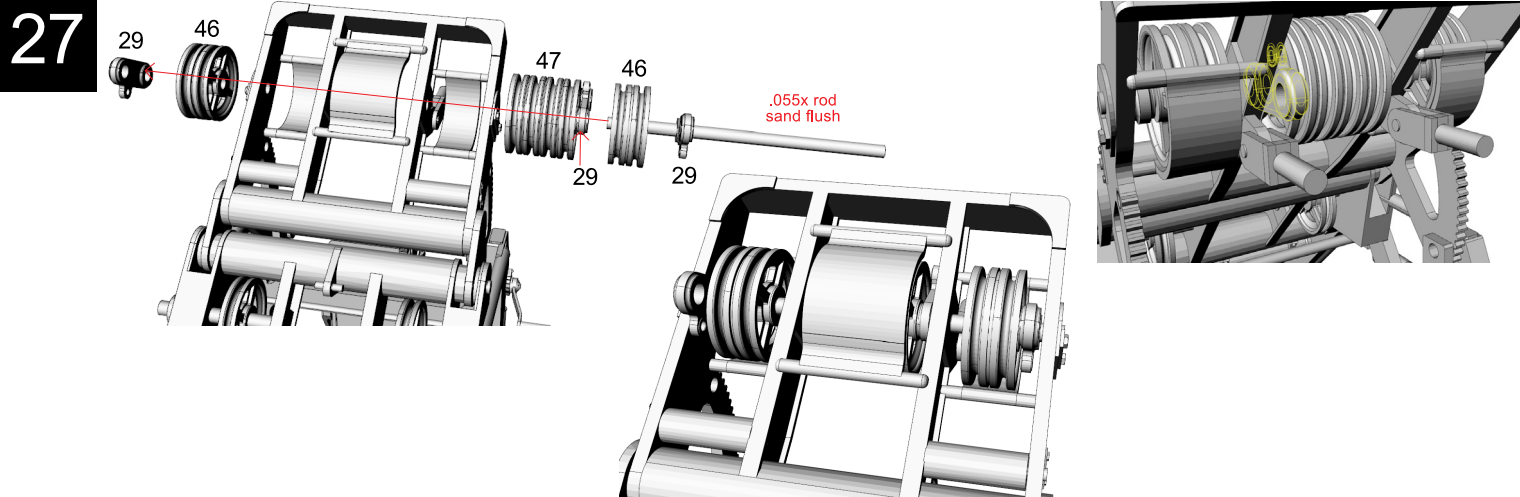

28

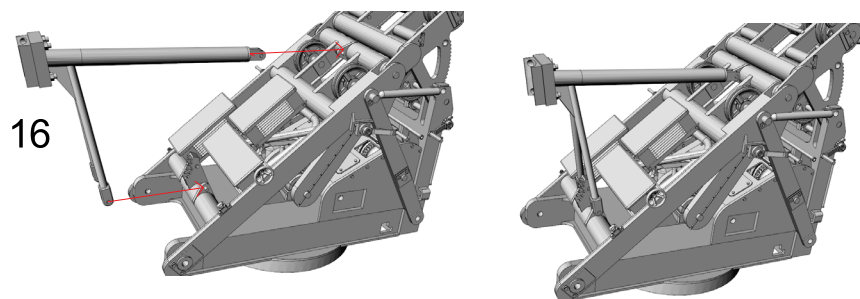

29

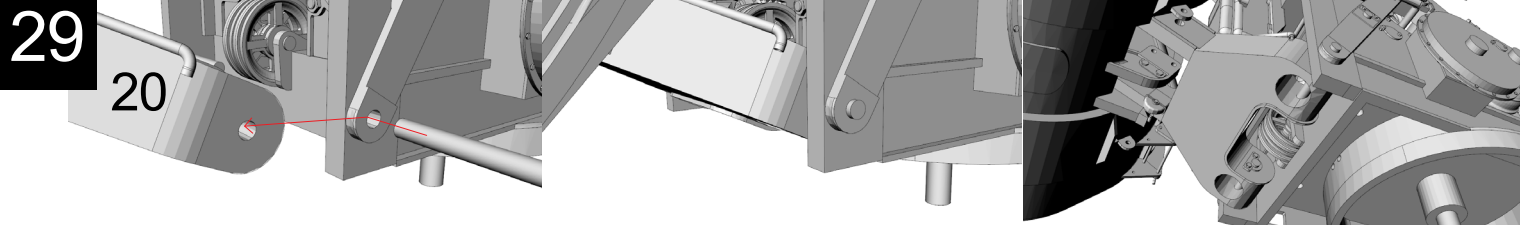

30

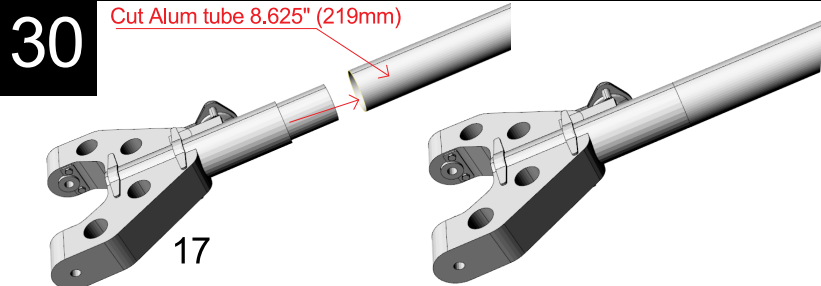

31

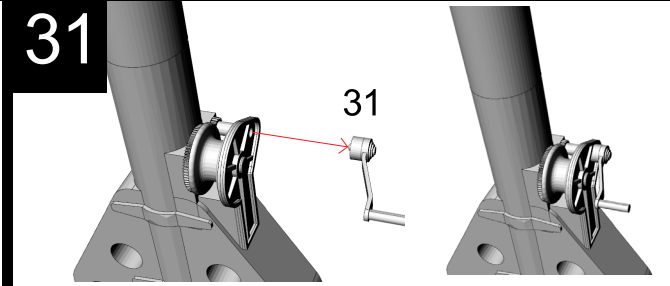

32

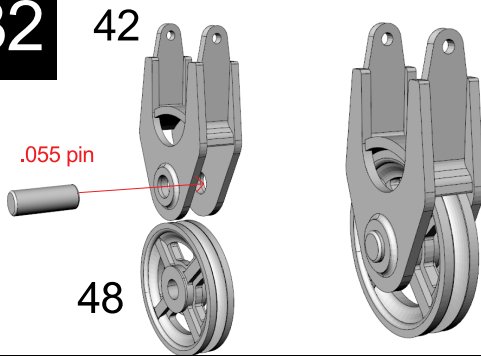

33

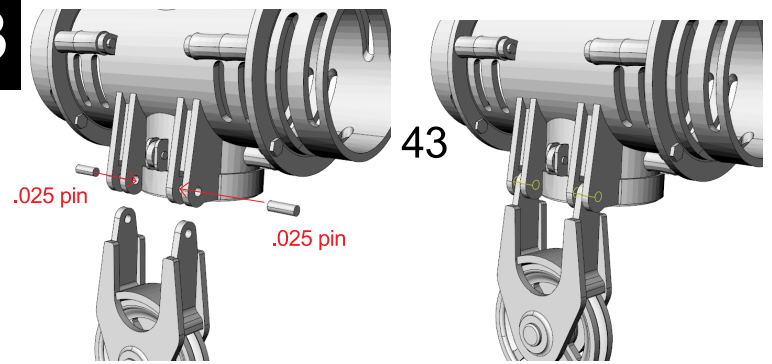

34

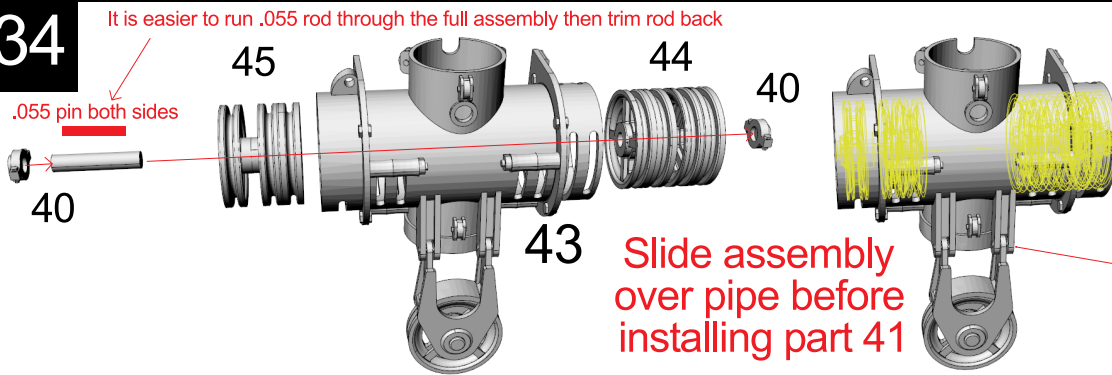

35

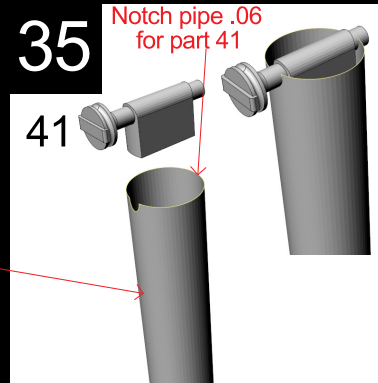

36

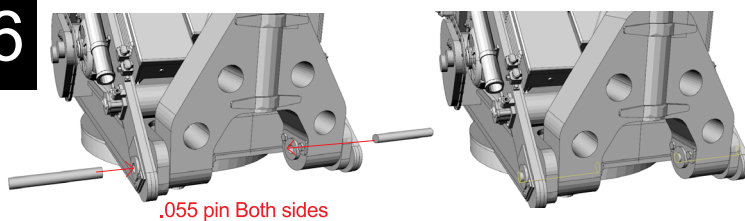

38

Included a spare part 36 if you want to cut you own angled .055 rod to replace part 37 to make it operational

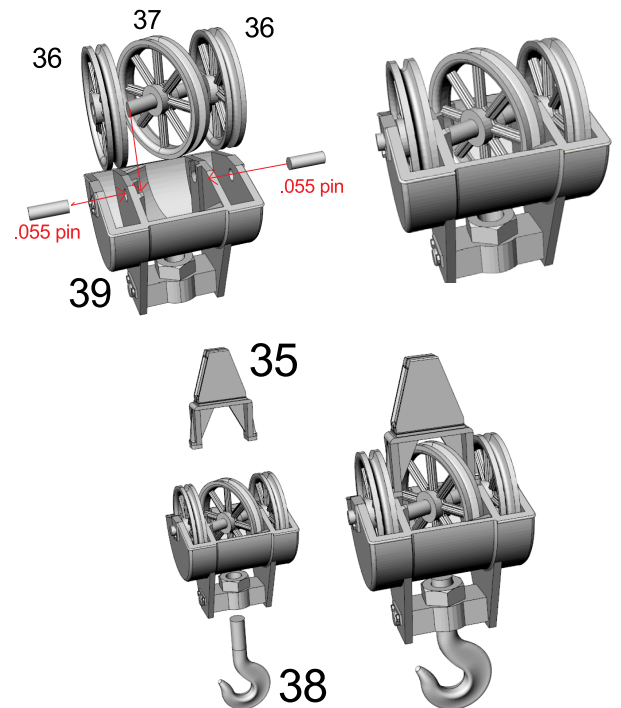

37

2-1.83x.8 tube

Part 61 hooks over rod on part 20 while crane is in operation and just rests on the frame while in travel mode or was removed and stored in aux. trailer with outriggers

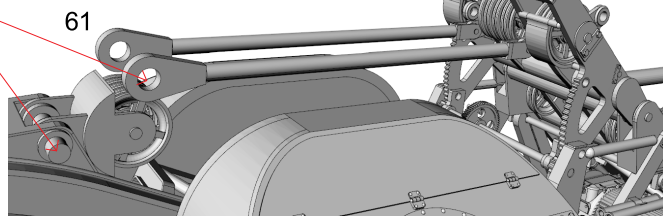

39

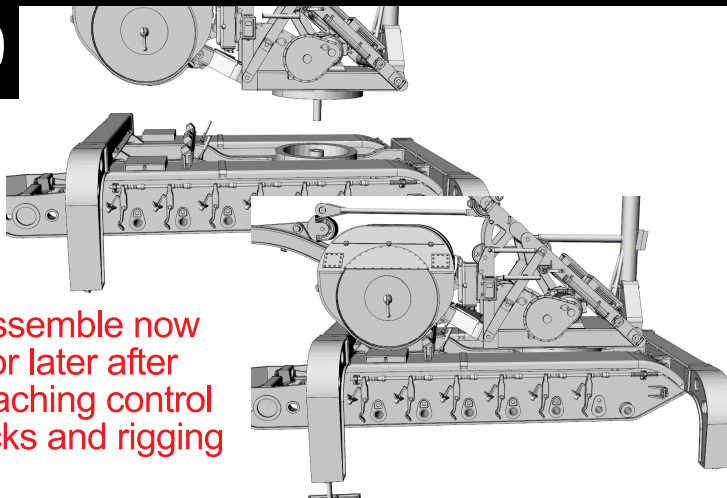

40

Replaces Tamiya part d35 paint mask is included

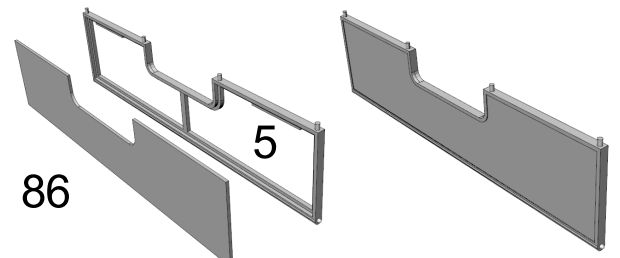

41

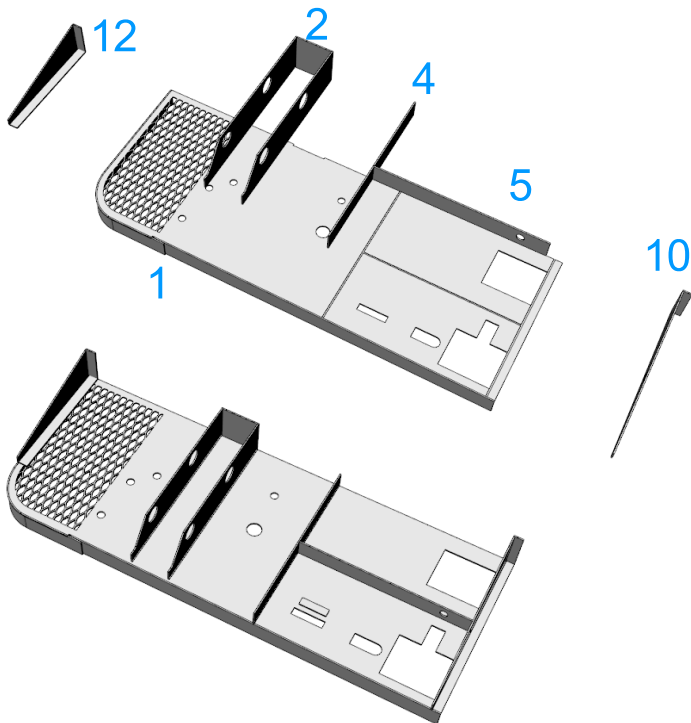
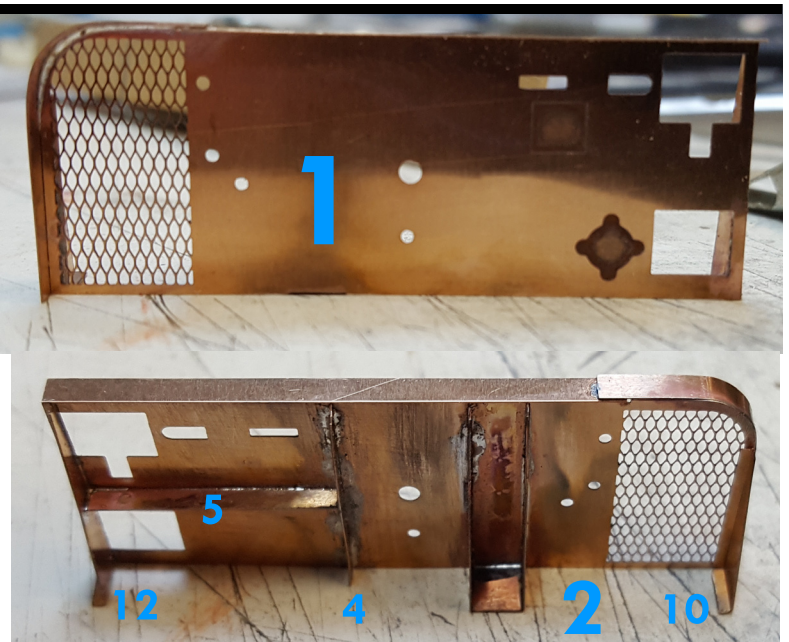
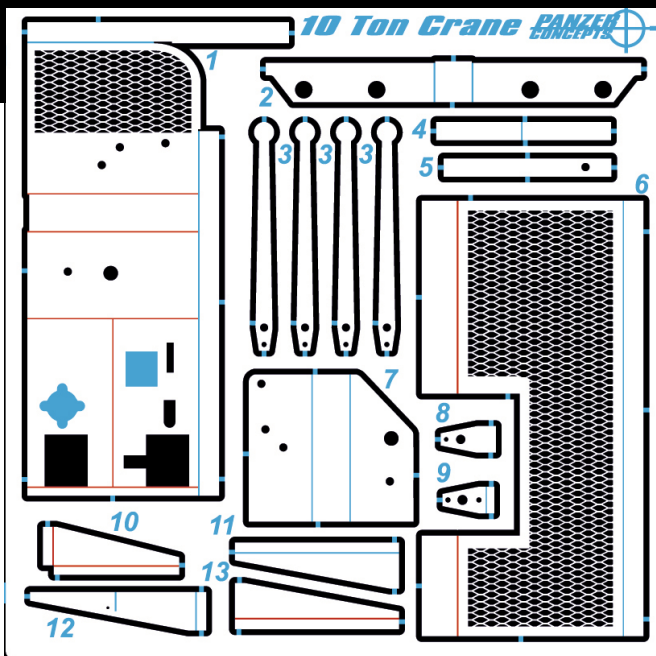

42

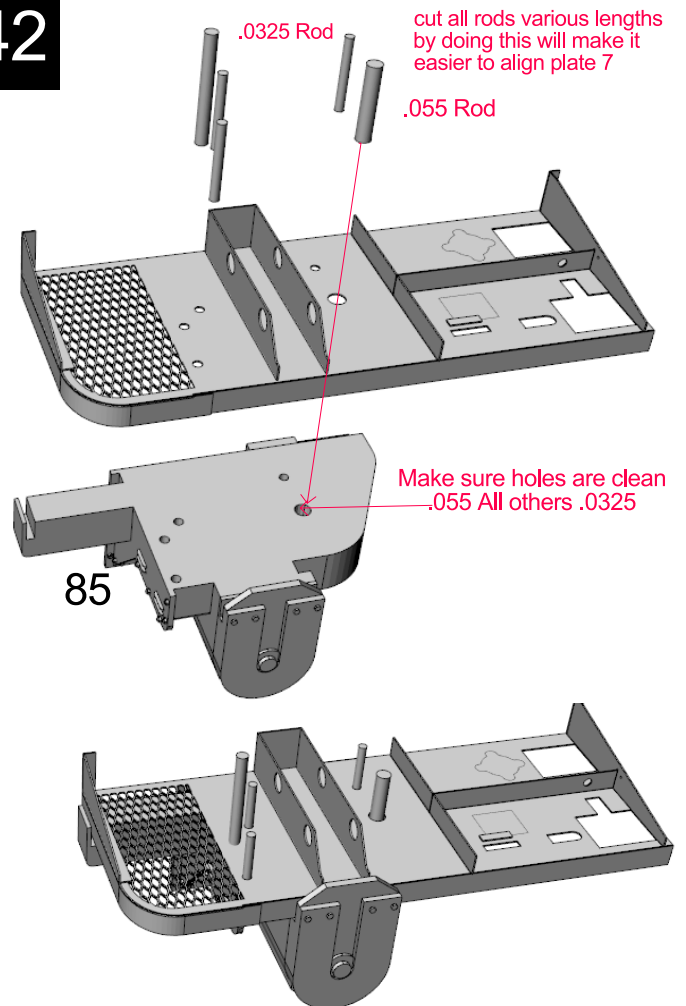

43

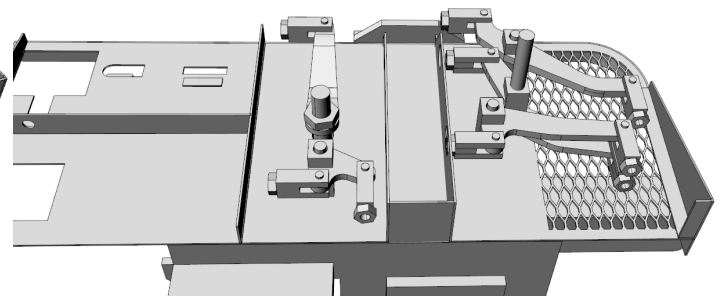
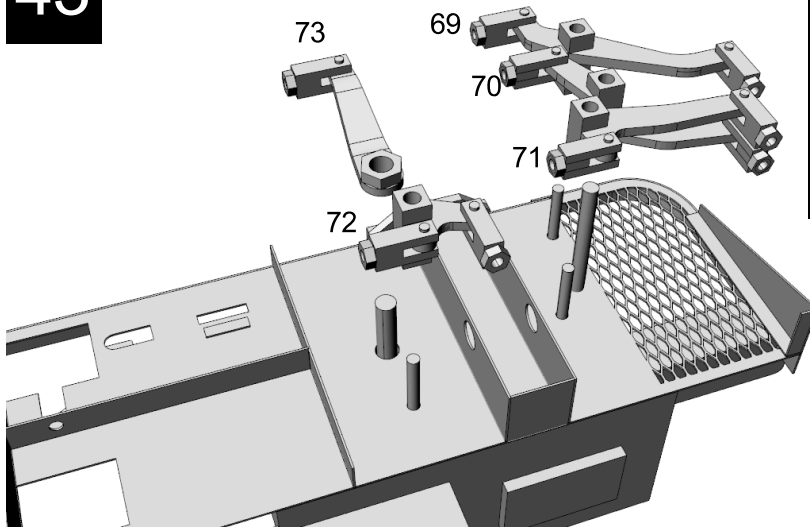

44

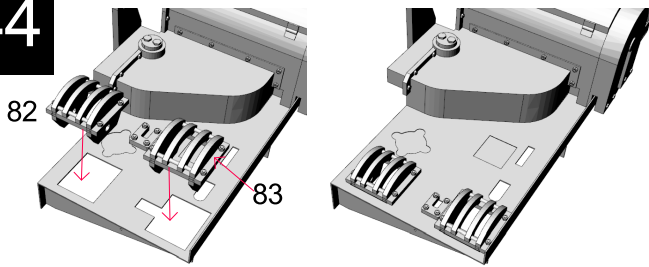

1
2
3
4
5
6

Winch Control
Rods .03

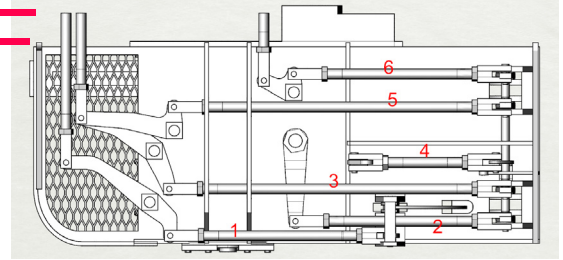

45

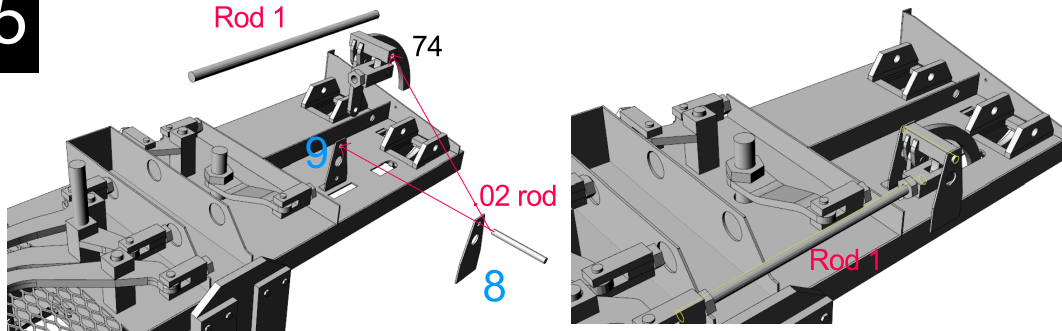

46

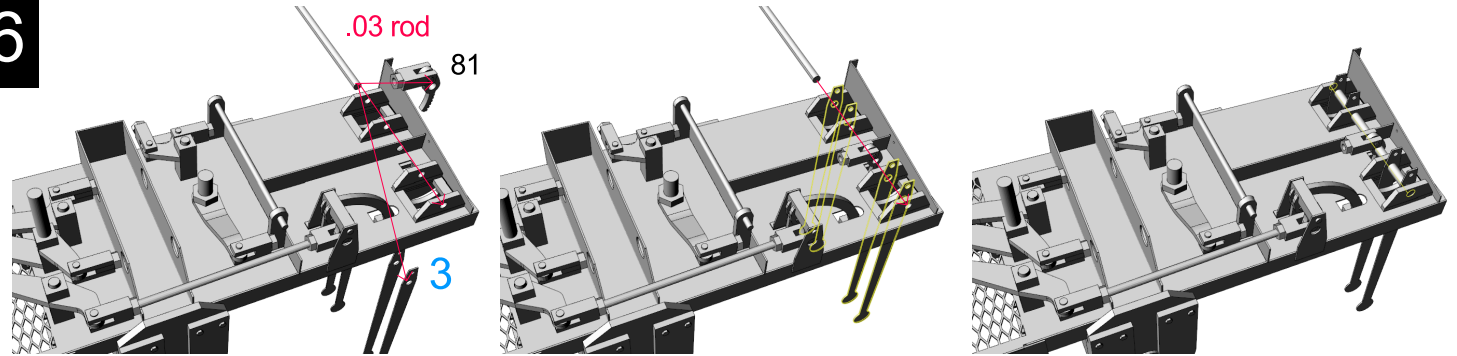

47

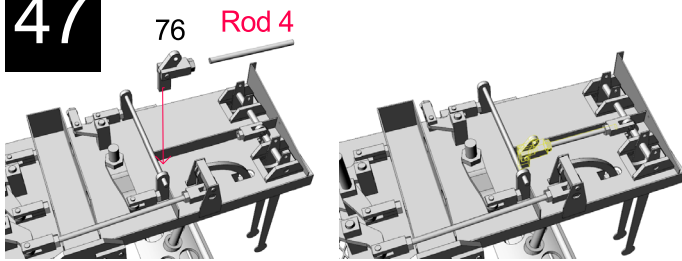

48

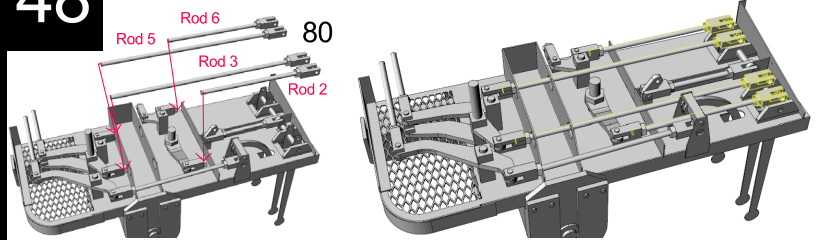

49

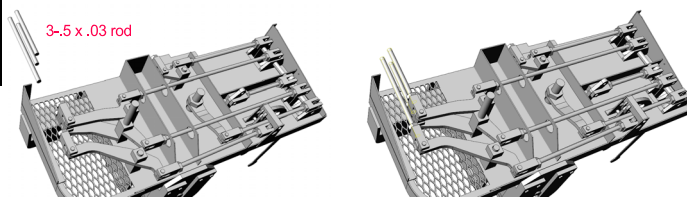

50

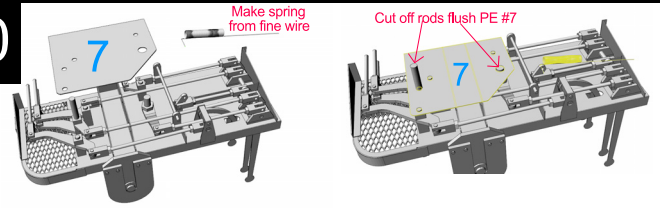

51

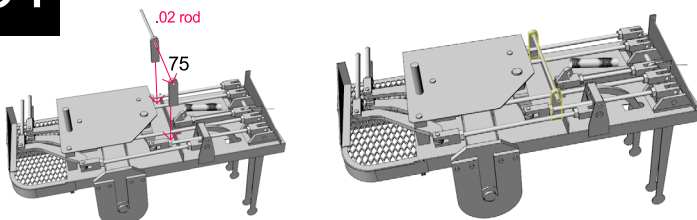

52

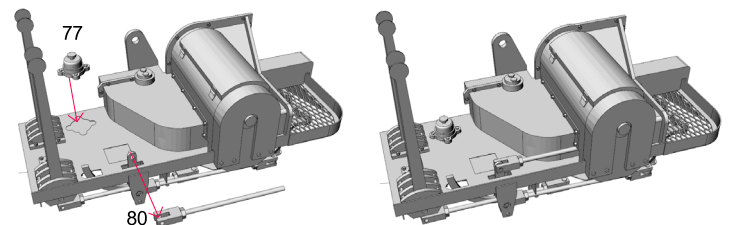

53

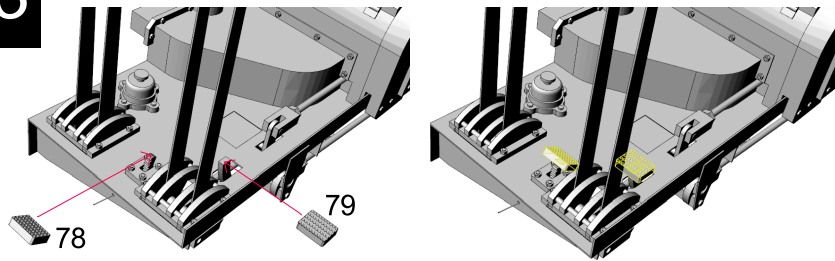

54

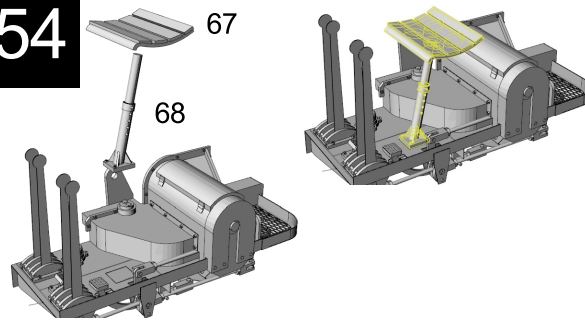

55

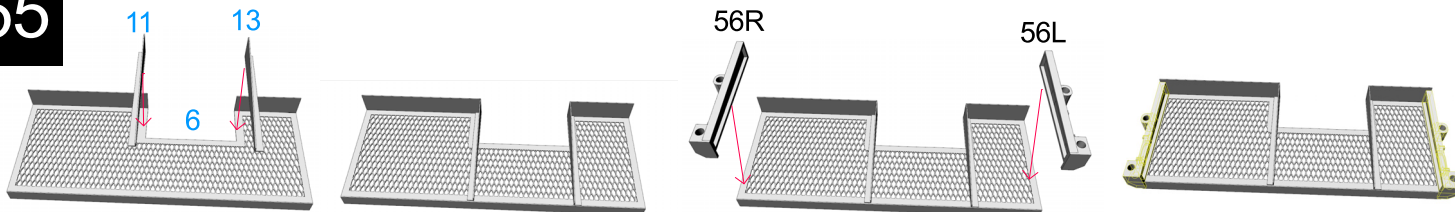

56

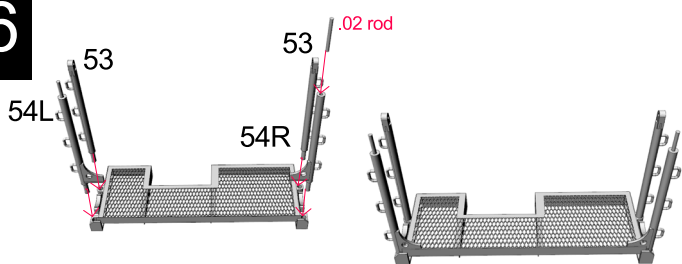

57

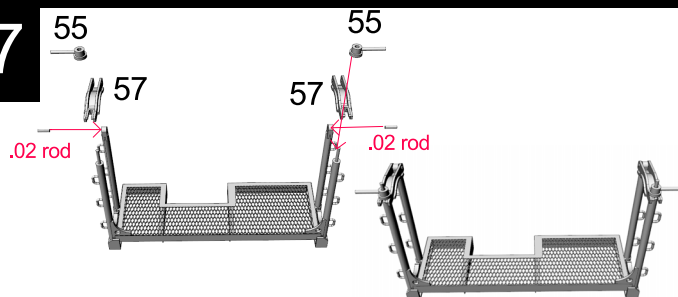

58

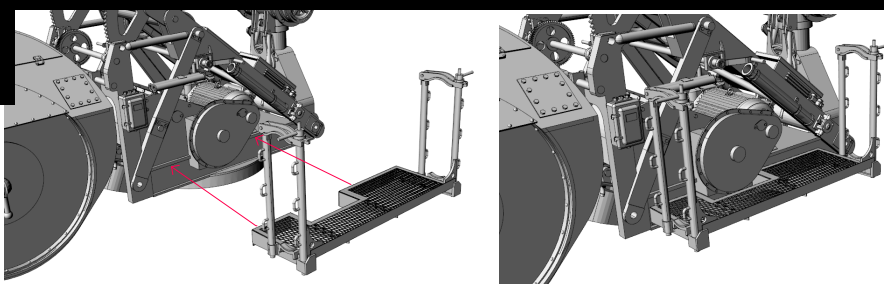

59

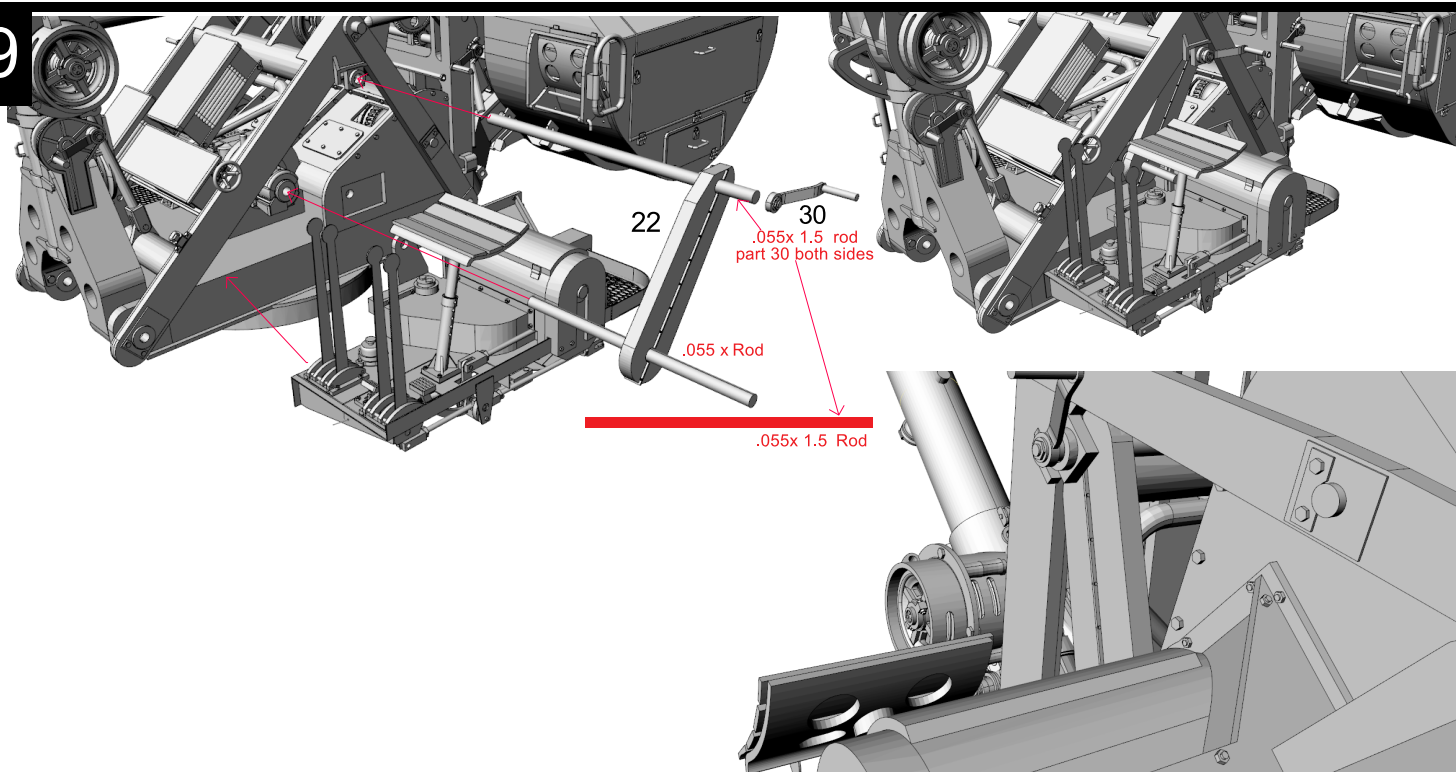

Final assembly and rigging

Cut yourself 3 sections of cable.

1-144" (3650mm) Boom line

1-24" (600mm) Counter weight frame line

1-36" (600mm) Lifting line.

This will vary depending on your requirements for a Diorama

Cut cable with a lighter or soldering iron to keep line from unravelling. Take one side and coat 2 inches or so with thin CA (super glue) when dry cut at slight angle creating a needle to aid in threading the line through the pulleys.

There is no easy way to rig this so take your time and don't forget to BREATHE.

For your final fixing of the cable I have included cable clamps, slide your cable through one side then loop through the fixture then back through the clamp leaving some extra then once you are ready to do your final fix just add a small drop of CA to fix in place.

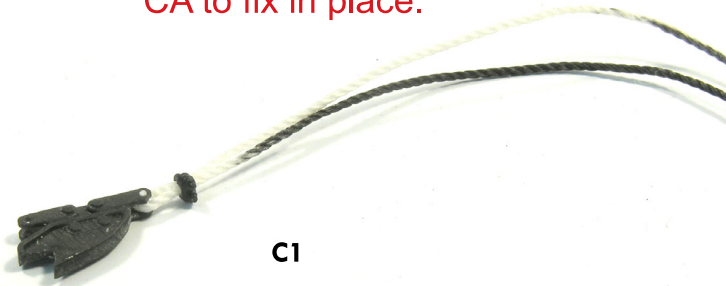

Attach your lines to the corresponding winch pulleys wrapping a few times or feed through holes in base then through the cover

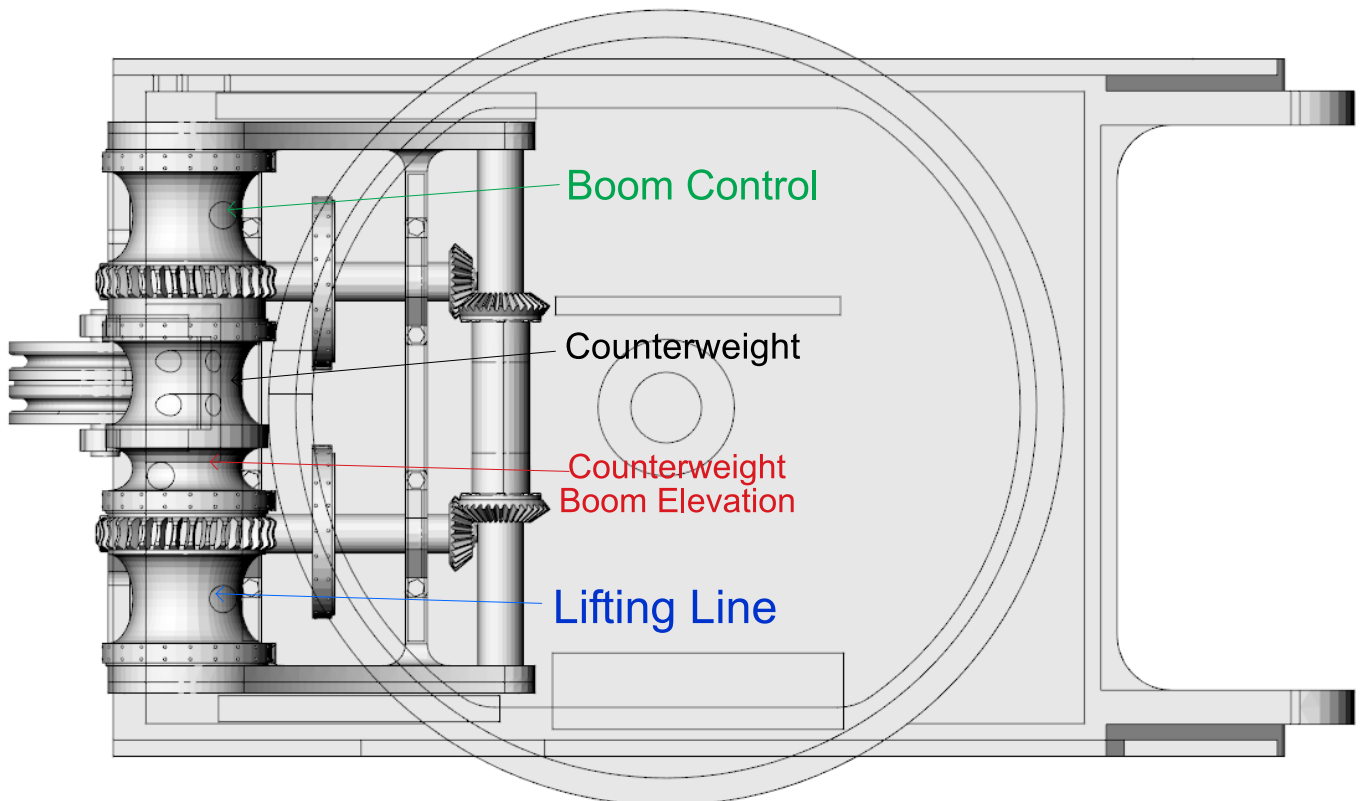

Counterweight Rigging

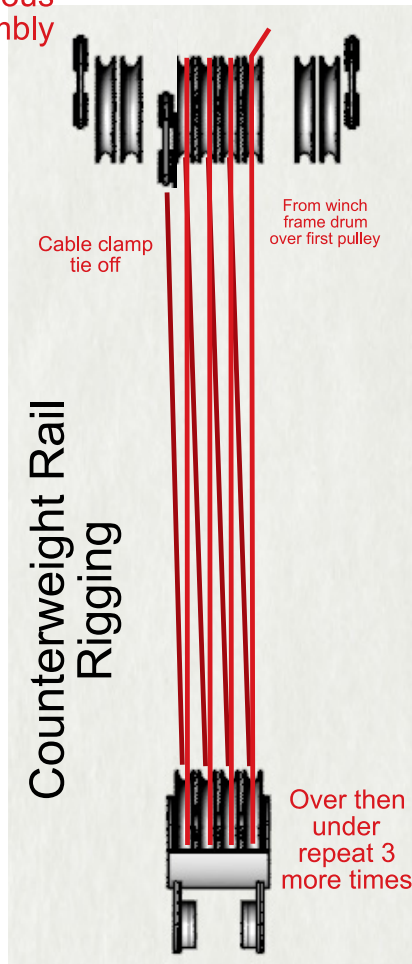
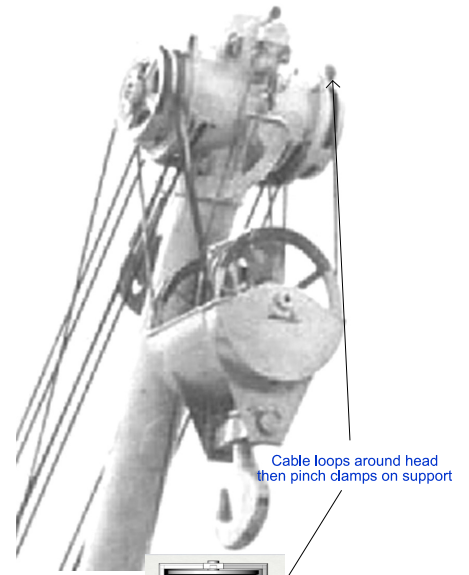
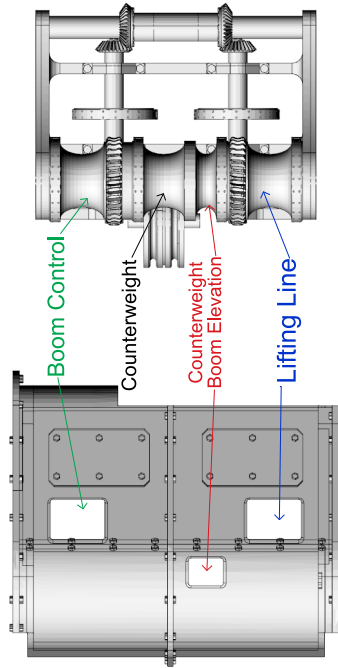
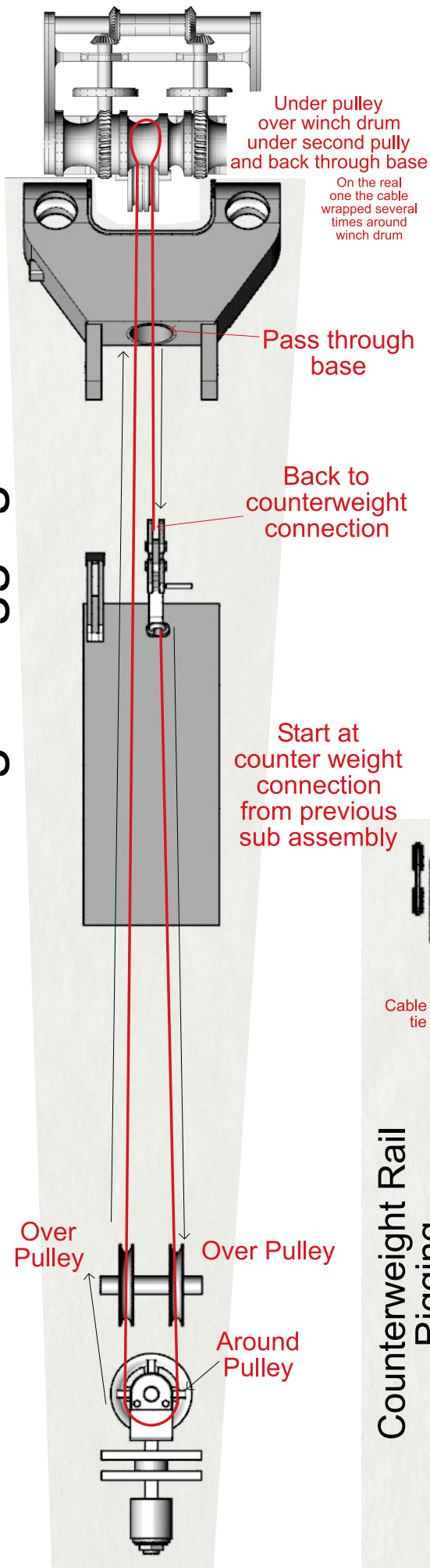

Counterweight Rail Rigging

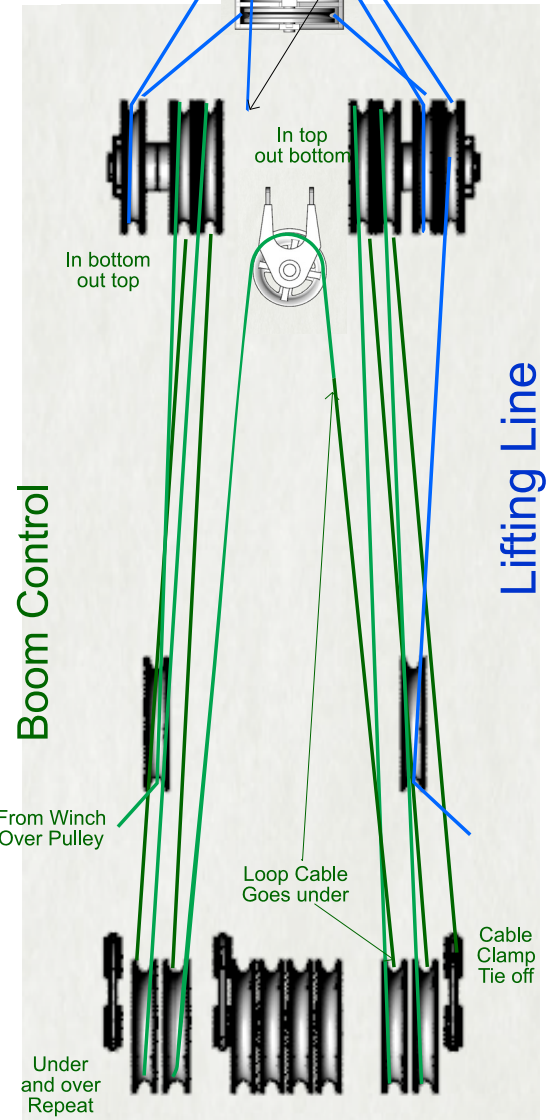

35004 Airbrake Kit

2

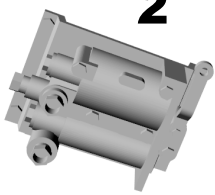

3



4

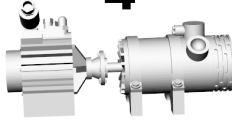

5



6

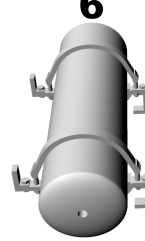

7x2

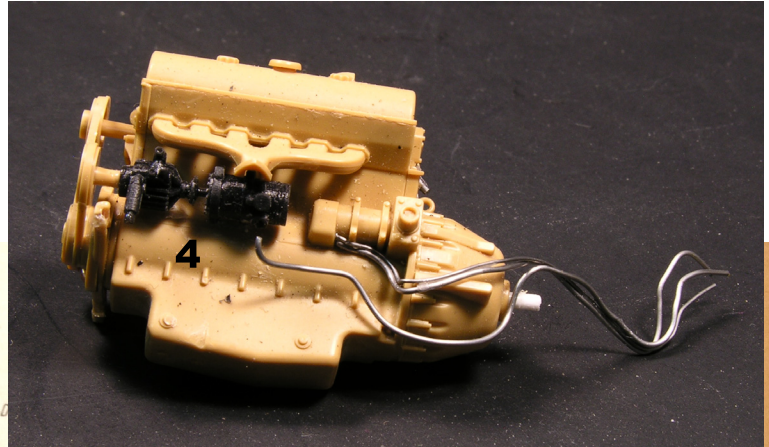
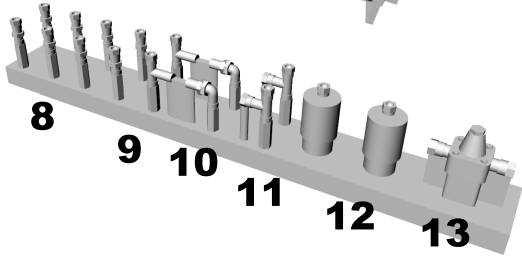
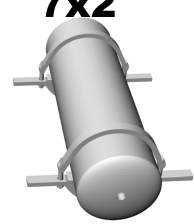

Attach Part 12 to the back of Tamiya part E19

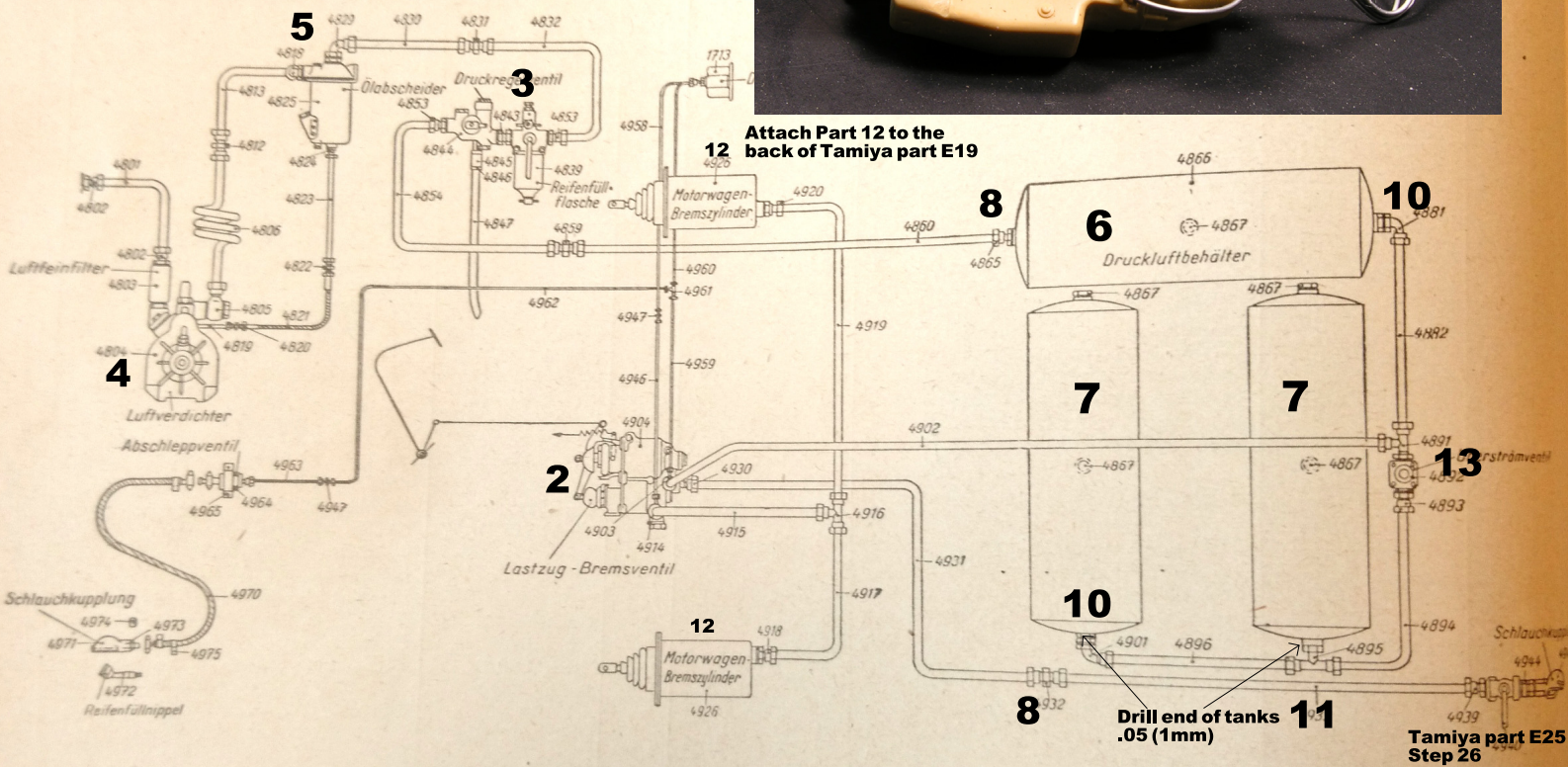

Drill end of tanks .05 (1mm)

Tamiya part E25 Step 26

5

lines to part 4

3

line to part 5

line to Airtank 1a

line to part 4

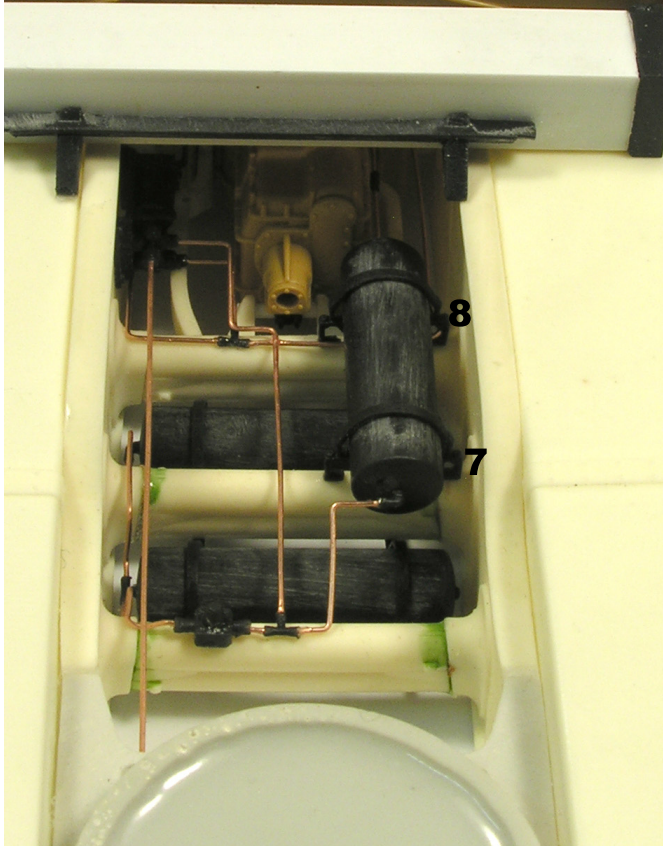
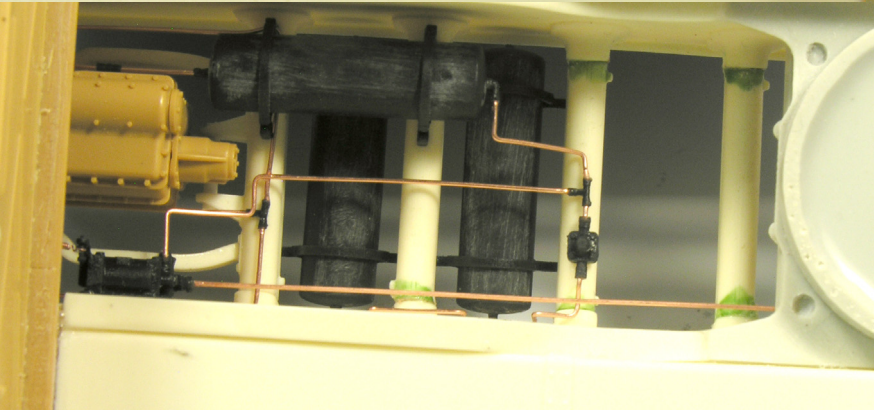
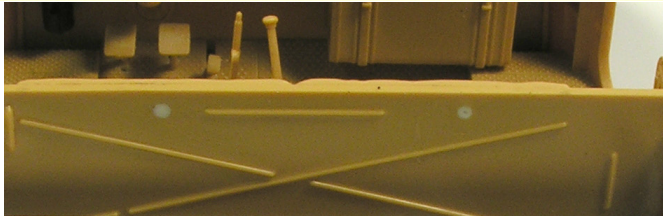
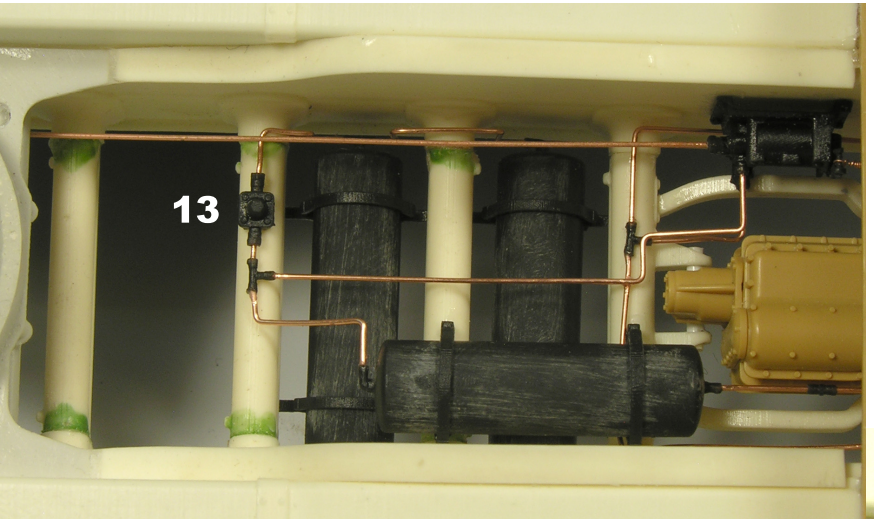
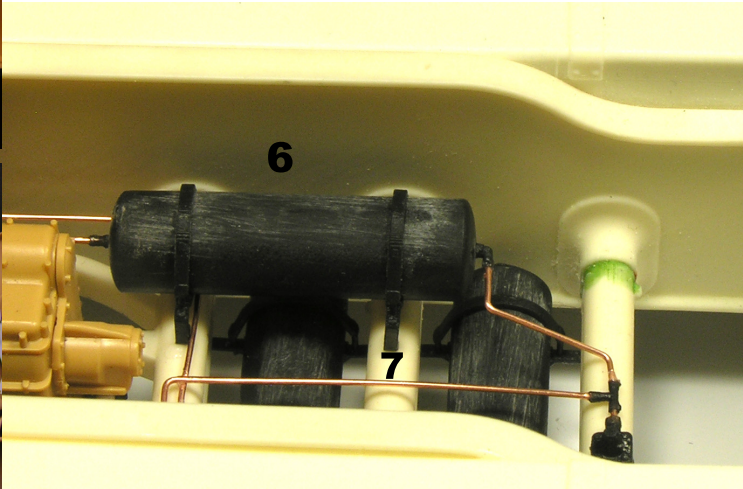
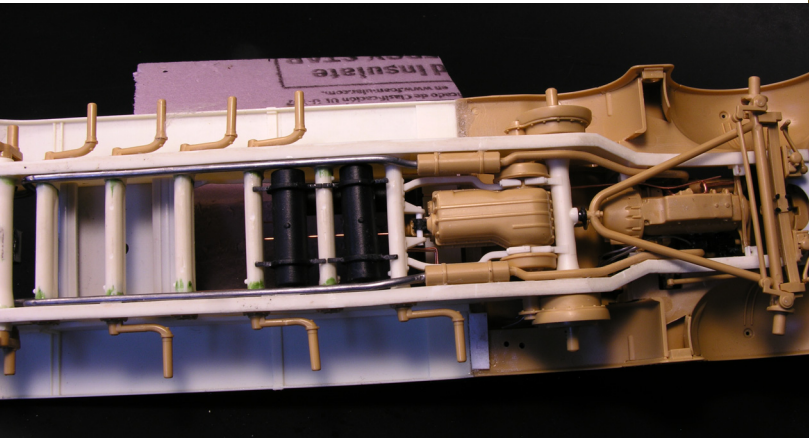
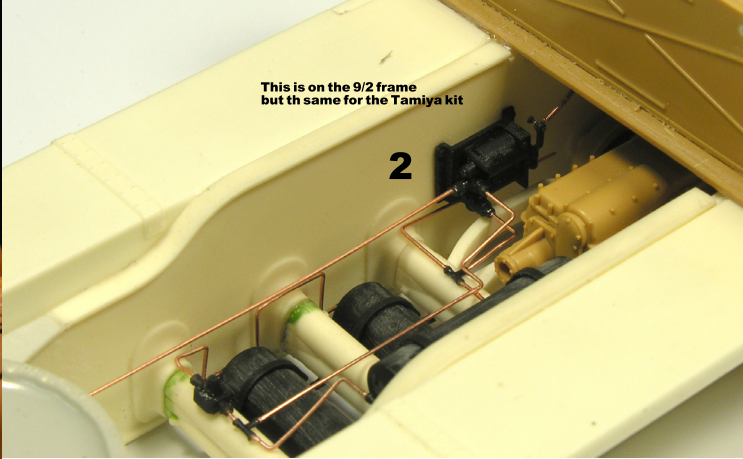
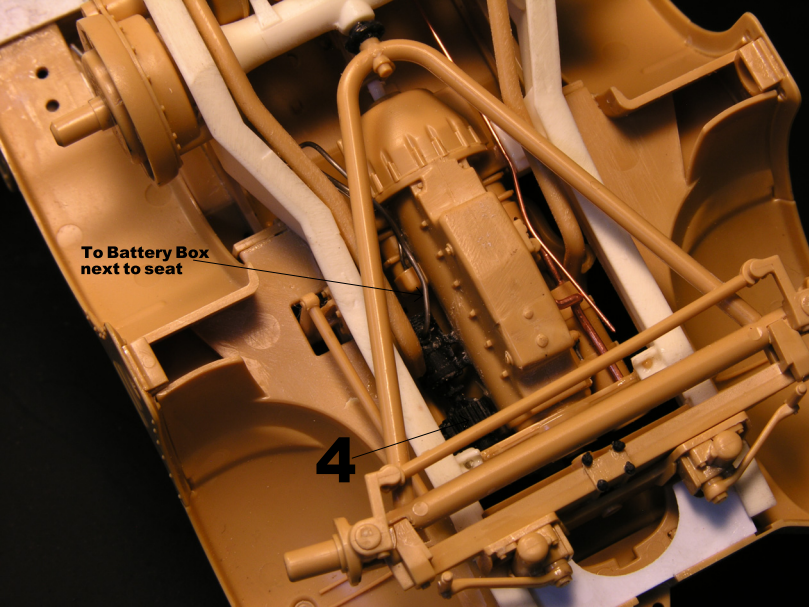





Nicht-Anlassen.
Schlechte Motor- oder Antriebs-
leistung vermeiden.
Druckknopf anlassen.
Schlechte Motor- oder Antriebs-
leistung vermeiden.



Die Schalterfunktion
Nicht-Anlassen
Schlechte Motor- oder Antriebs-
leistung vermeiden.
Druckknopf anlassen.
Schlechte Motor- oder Antriebs-
leistung vermeiden.

