

Keep all parts flush with each other. I use glass as a flat base

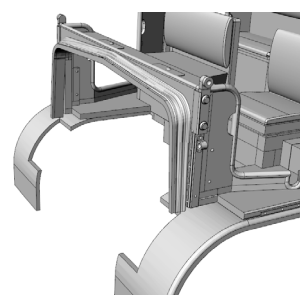

14

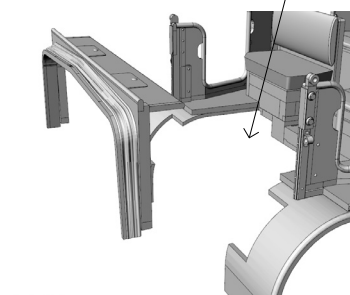
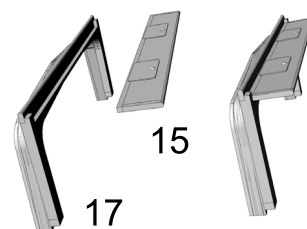
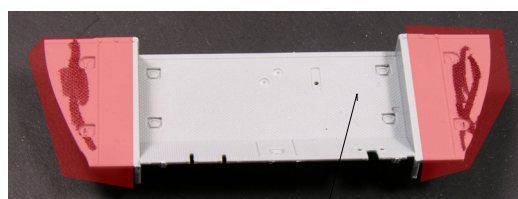
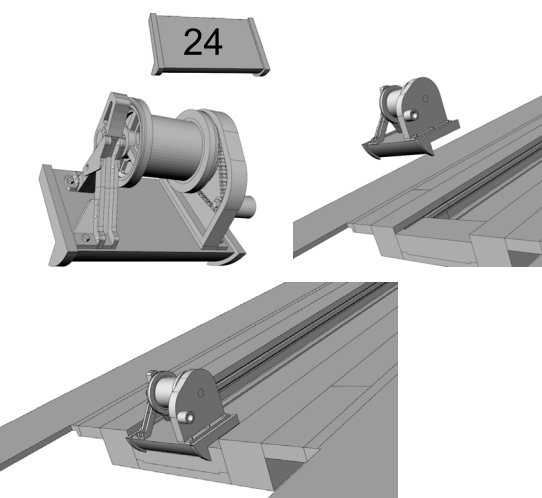
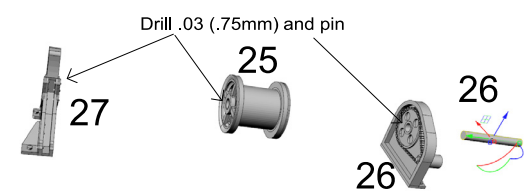
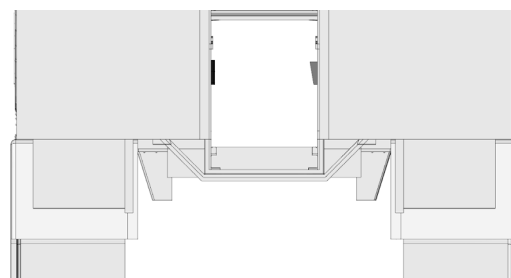
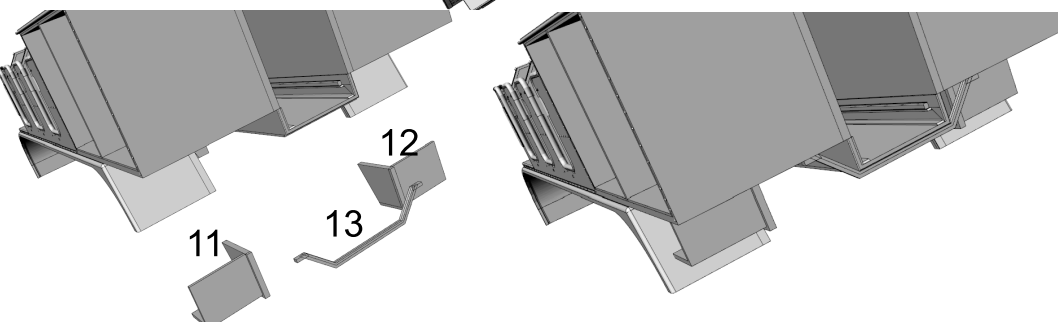
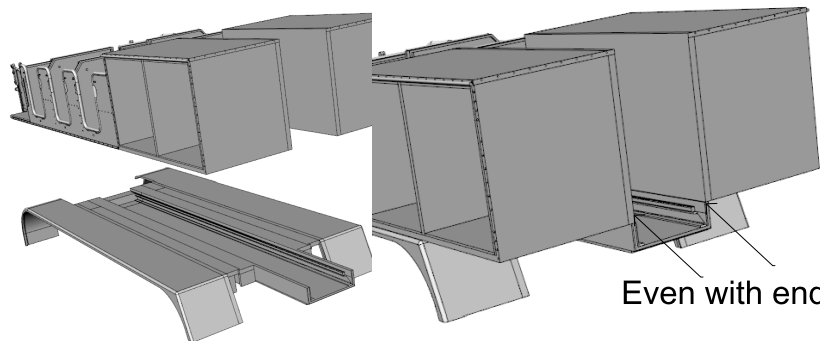
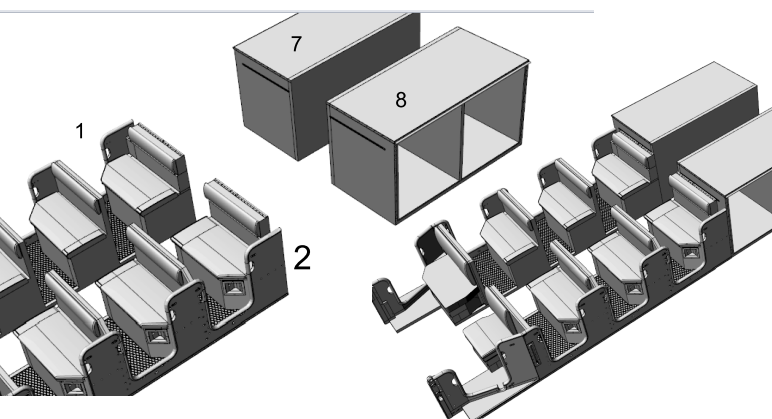
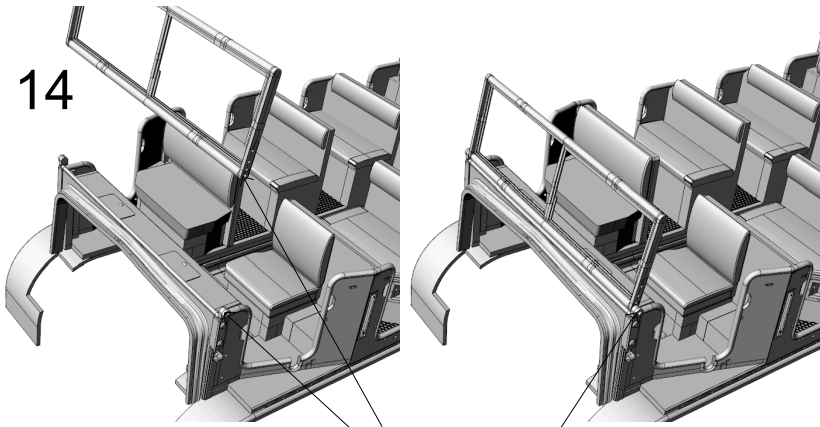

Drill .02 (.5mm) and Pin

18x12

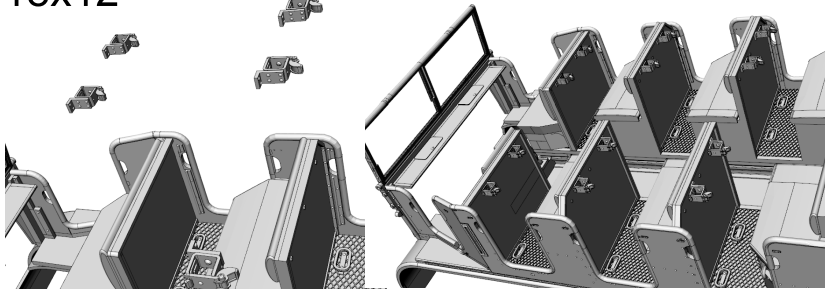

20&21x6

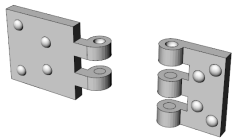

Drill .01 (.3mm) and Pin to make movable

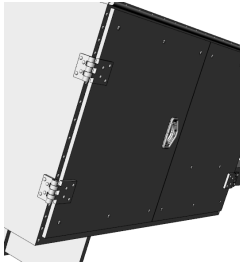
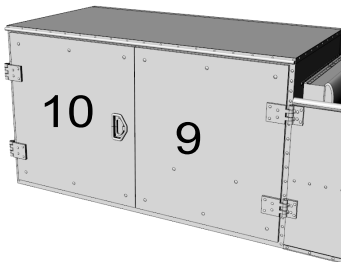
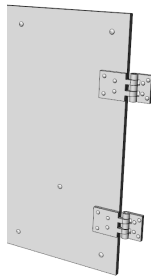

02 (.5mm) Rod

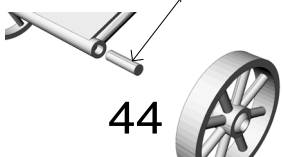

44

Make from Plastic or Brass strip

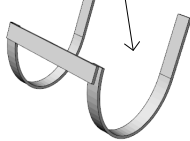

43

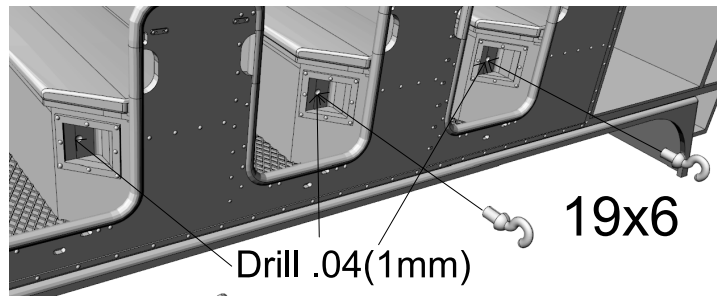
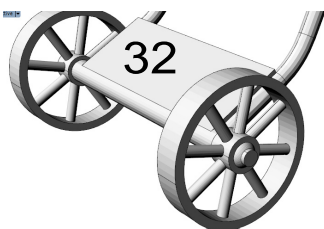

19x6

Drill .04(1mm)

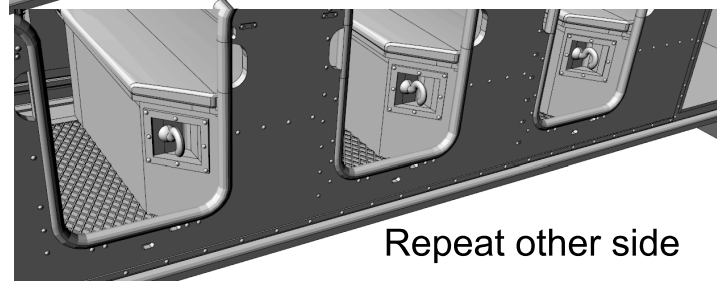

Repeat other side

29x12

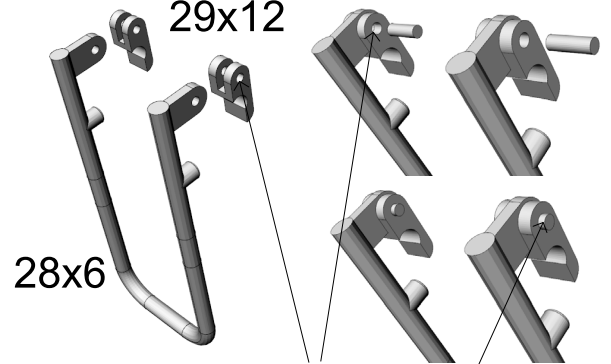

28x6

Drill .02 (.5mm) and Pin to make movable

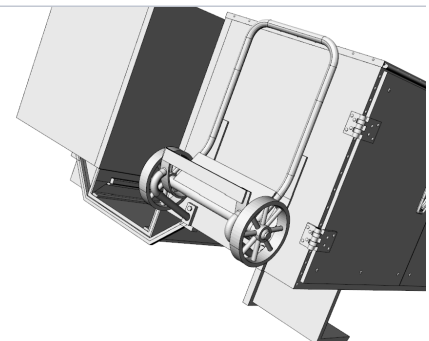
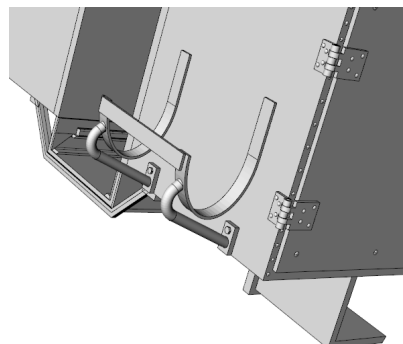
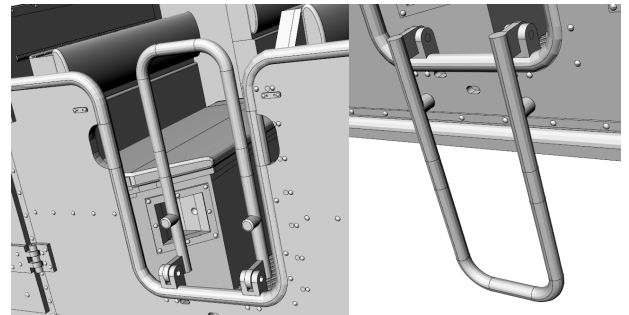

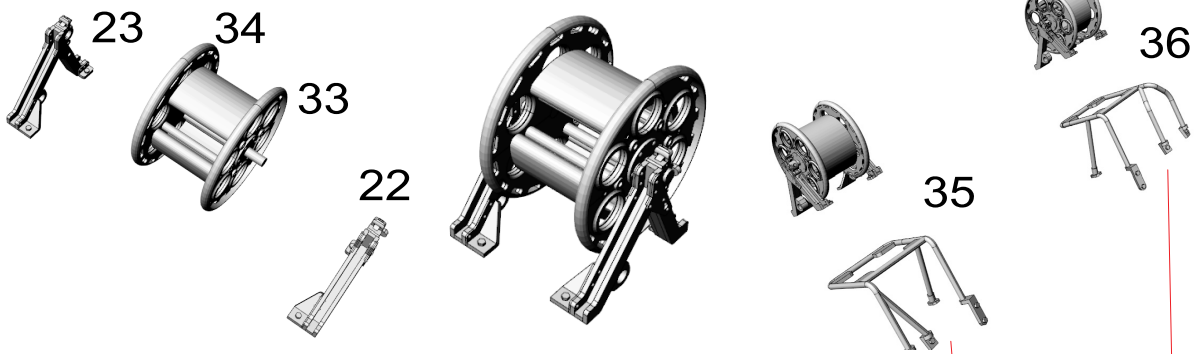

Drill .03 (.75mm)

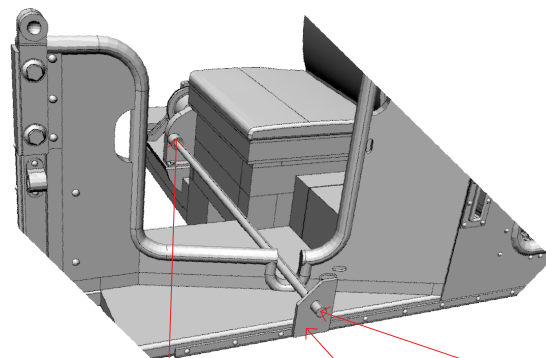
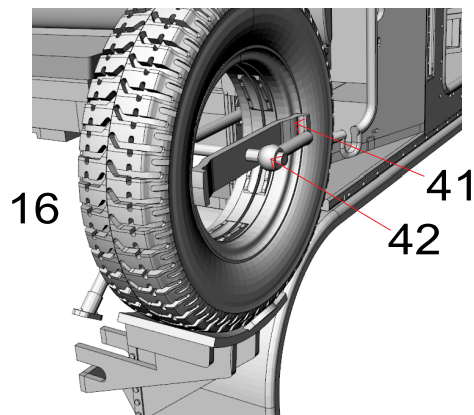
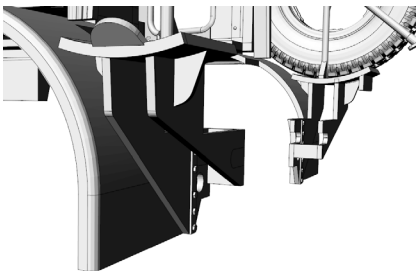
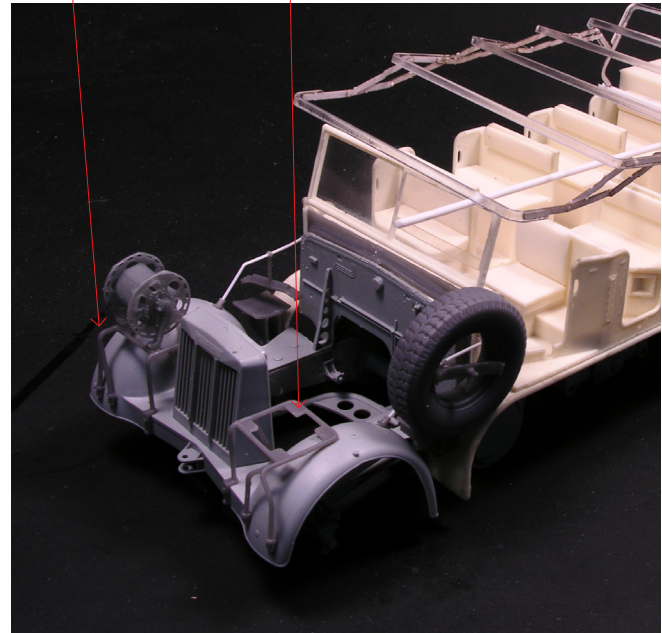
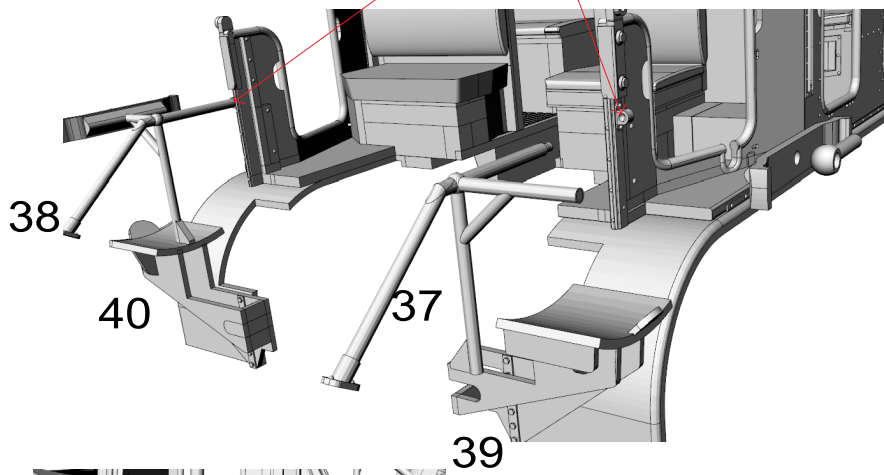

Support cut from .01 off cut sheet
Drill and use .03 x 1..2 (.7 x 30mm) Rod

READ VERY IMPORTANT
For the card stock to work properly
you **MUST** seal it with thin CA. This
makes the card very rigid so it can be
drilled and pinned

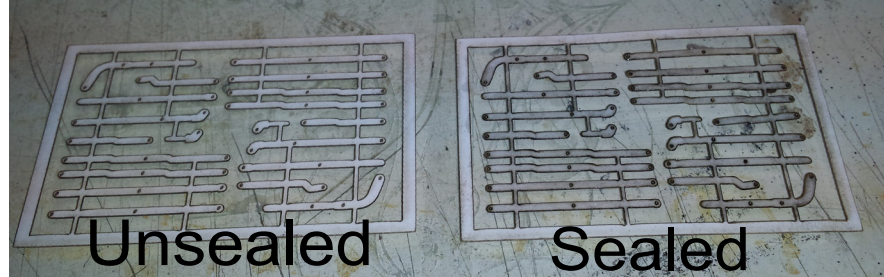

Shown without Bows

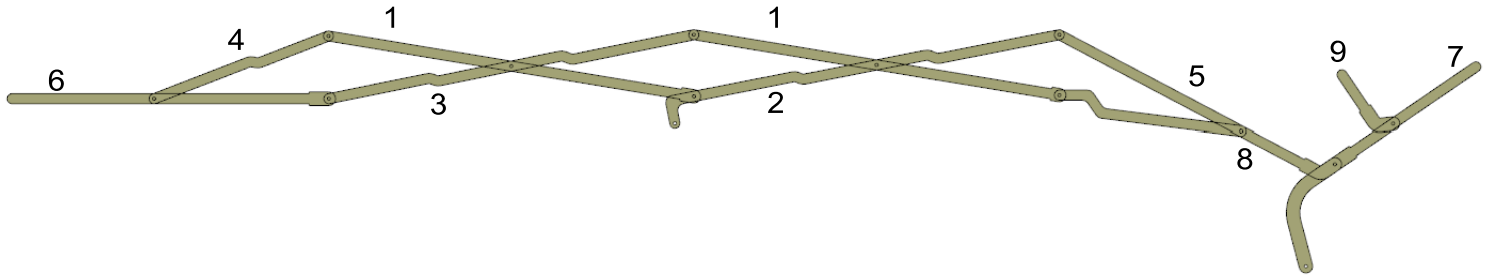

The Notch on the end should
line up with the end of the bows

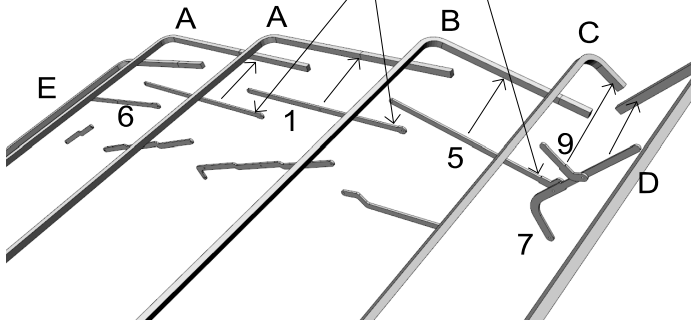

To make functional drill with .02 then pin.

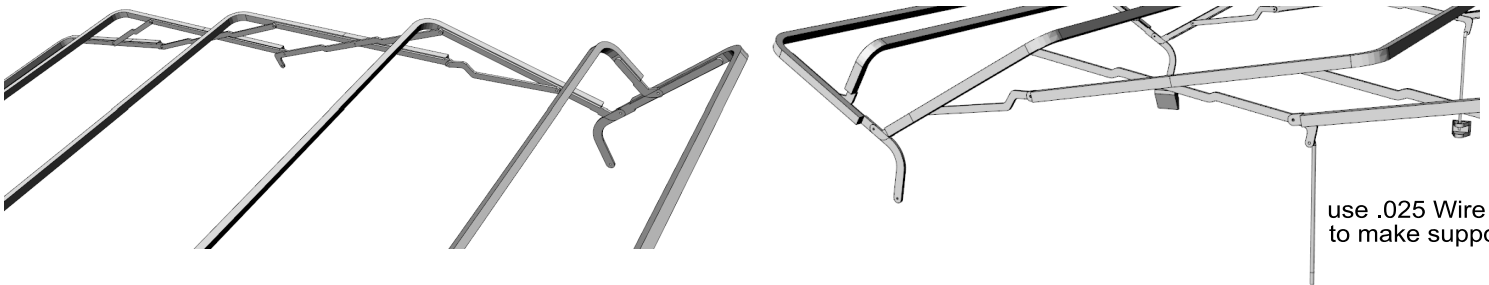
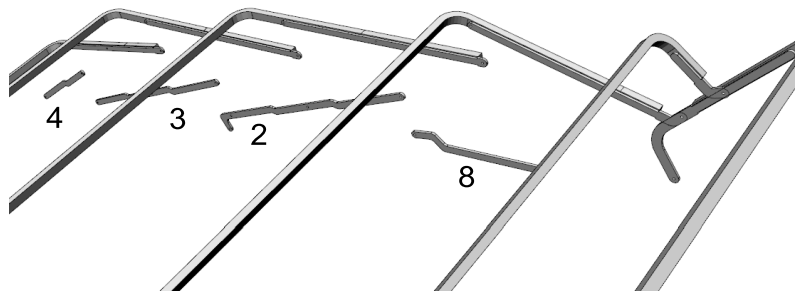

use .025 Wire
to make support

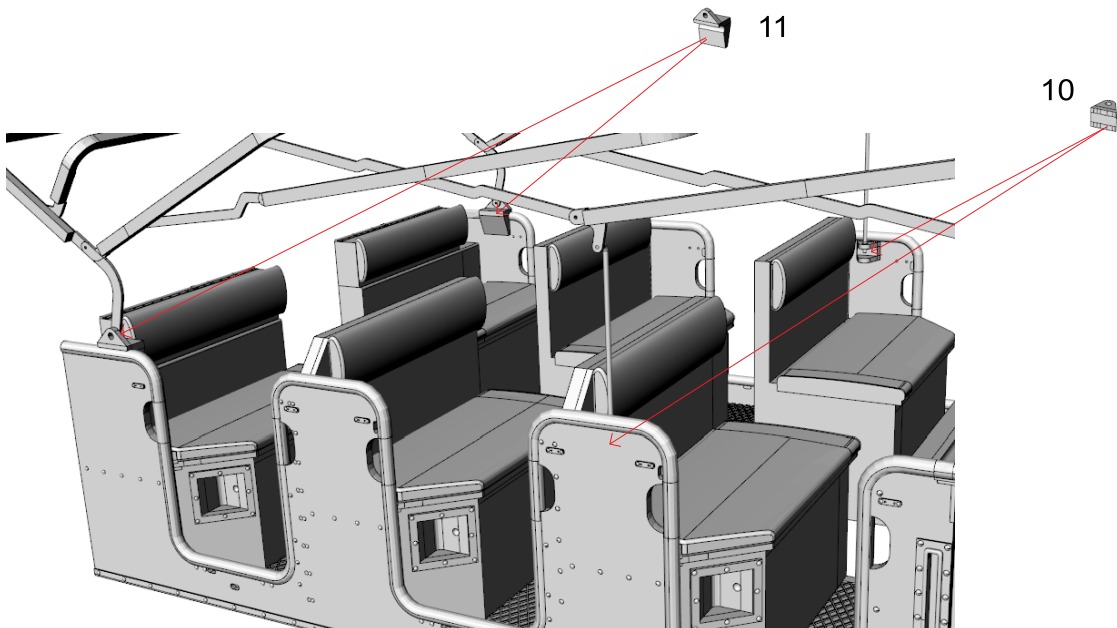

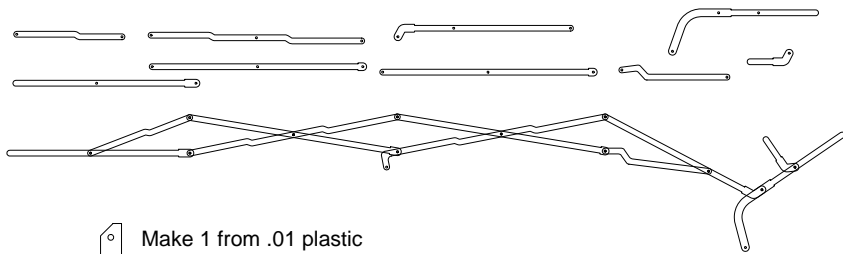
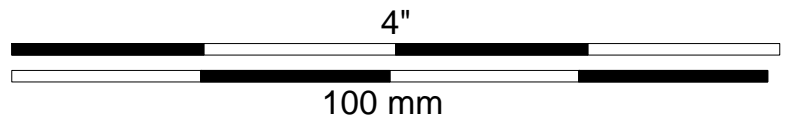

Make 1 from .01 plastic

